

e sales@laminghope.com
t 020 3617 1333

L&Hresidential
laminghope.com sales & lettings



Brook Road, Borehamwood, WD6

£349,959

- Recently built (2018)
- 3rd floor flat with lift
- Two double bedrooms
- Open plan living space
- Secure underground parking space
- West facing balcony
- Overlooks the communal gardens
- 0.6 miles from Elstree and Borehamwood train station
- Long lease





L&H Residential are proud to bring to the market this recently built and spacious flat located just 0.6 miles from Elstree and Borehamwood train station and a short walk to local amenities schools and places of worship. The accommodation comprises of; two double bedrooms, bathroom, open plan kitchen/living area and a west facing balcony. The property has many great features as well as being excellently located it has; a secure underground parking space, lift, overlooks the communal gardens and has a long lease.

Lounge

Kitchen

Bedrooms

Bathroom



Brook Road, Borehamwood, WD6

£349,959

A spacious and recently built (2018) two double bedroom third floor flat with secure underground parking and located just 0.6 miles from Elstree and Borehamwood train station.





Franklin Court, Brook Road, WD6

Approximate Gross Internal Area = 72.4 sq m / 779 sq ft

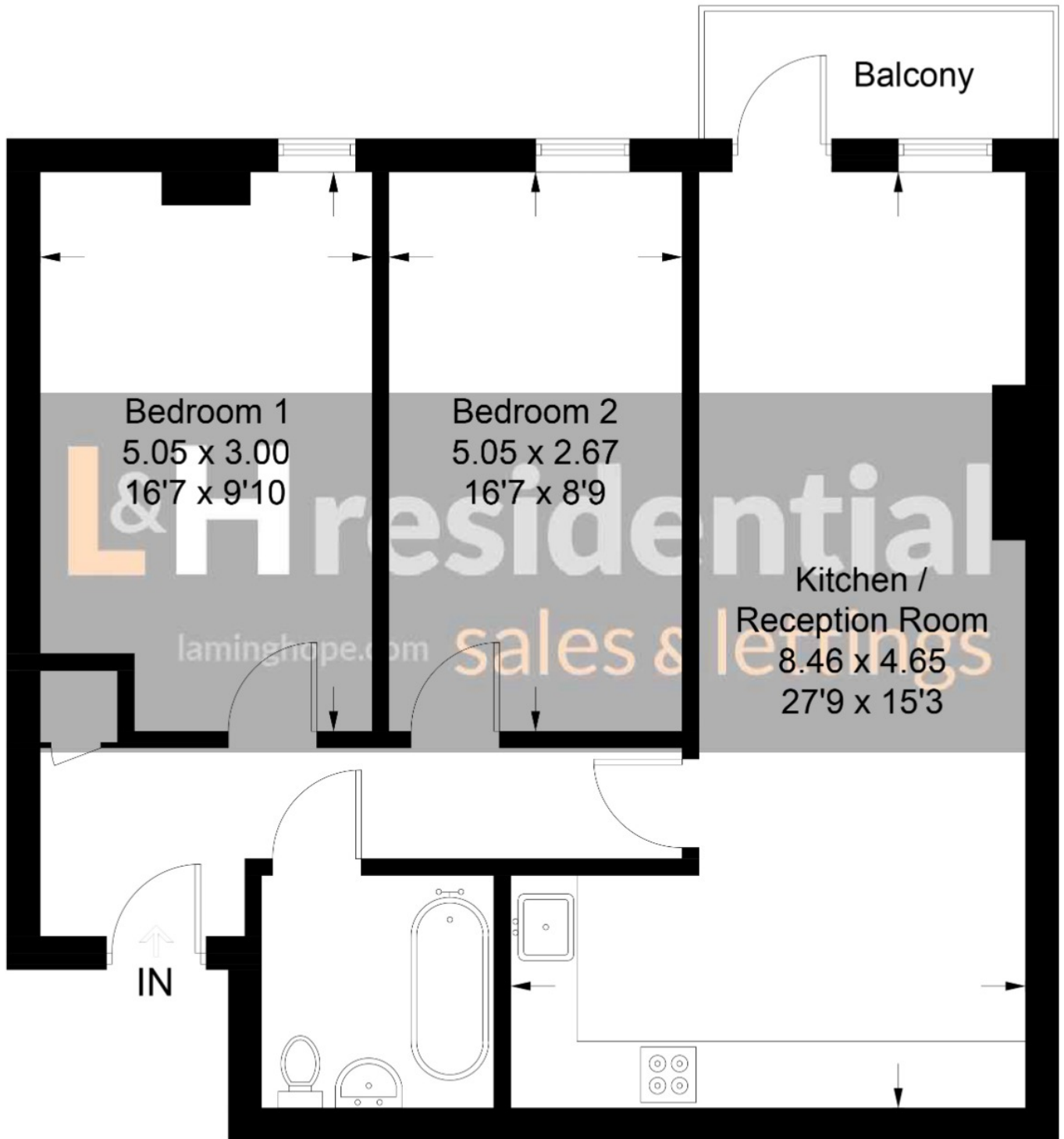

Third Floor

Illustration for identification purposes only, measurements are approximate, not to scale. floorplansUsketch.com © (ID656492)

12 Shenley Road, Borehamwood, Hertfordshire, WD6 1DL

T: 020 3617 1333

E: enquiries@laminghope.com