

e sales@laminghope.com
t 020 3617 1333

L&Hresidential
laminghope.com sales & lettings



Brook Road, Borehamwood, WD6

£250,000

- Recently built (2018)
- 5th floor flat with lift
- One bedroom
- Open plan living space
- Underground parking space
- 0.7 miles from Elstree and Borehamwood train station
- Communal gardens
- EWS1 CERTIFIED





L&H Residential are proud to bring to the market this recently built (2018) spacious fifth floor flat. The accommodation comprises of; bedroom, bathroom, and open plan kitchen/living area. The property has many great features as well as being excellently located it has an underground parking space and use of communal gardens.

An early viewing is advised.

Kitchen

Living Room

Bedroom

Bathroom



Brook Road, Borehamwood, WD6

£250,000

Recently built and spacious one bedroom fifth floor flat with lift. Located just 0.7 miles from Elstree & Borehamwood train station and a short walk to local shops and bus routes

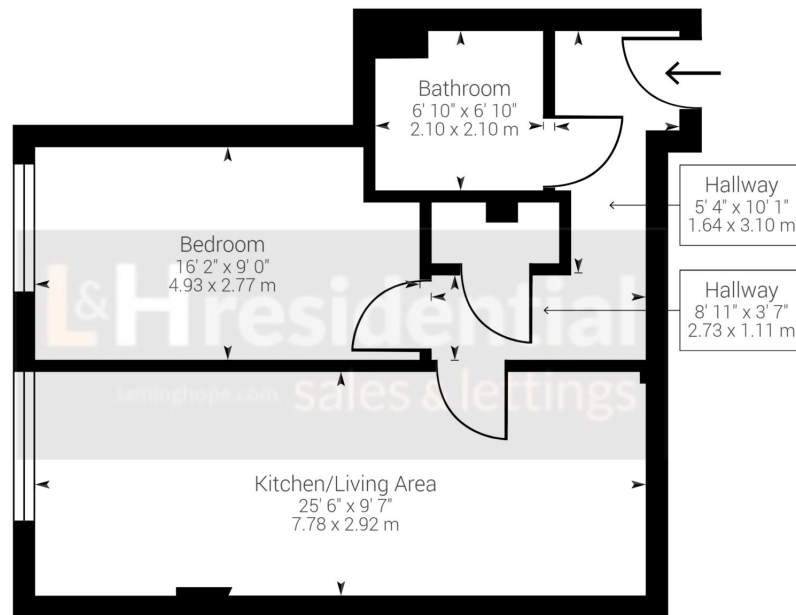

Approximate net internal area: 530.13 ft² / 49.25 m²

While every attempt has been made to ensure accuracy, all measurements are approximate, not to scale. This floor plan is for illustrative purpose only and should be used as such by any prospective tenant or purchaser.

Powered by Giraffe360

Laminghope

12 Shenley Road, Borehamwood, Hertfordshire, WD6 1DL

T: 020 3617 1333

E: enquiries@laminghope.com