

e sales@laminghope.com

t 020 3617 1333

L&Hresidential
laminghope.com sales & lettings



Byron Avenue, WD6

£1,450 pcm

- Three bedroom end of terrace house
- Spacious eat in kitchen
- Separate lounge
- Downstairs guest WC
- 0.4 miles from Elstree and Borehamwood train station
- Short walk to local shops and Yavneh College
- 30ft private garden
- Lots of on street parking available
- Move in from 2/6/20
- Unfurnished/Furnished





L&H Residential are proud to bring to the market this spacious end of terrace house located on the south side of Borehamwood within just 0.4 miles of Elstree and Borehamwood train station and a short walk to local shops, amenities and Yavneh College. The accommodation comprises of; three bedrooms, family bathroom, downstairs guest WC, spacious eat in kitchen and a reception room. The property also benefits from having a private 30ft garden and plenty of on street parking.

An early viewing is advised
Unfurnished/Furnished
Move in date from 2/6/20



Byron Avenue, WD6

£1,450 pcm

A well presented three bedroom end of terrace house located on the south side of Borehamwood within just 0.4 miles of Elstree and Borehamwood train station and a short walk to local shops and Yavneh Collge.





Byron Avenue, WD6

Approximate Gross Internal Area = 86.0 sq m / 926 sq ft



Ground Floor

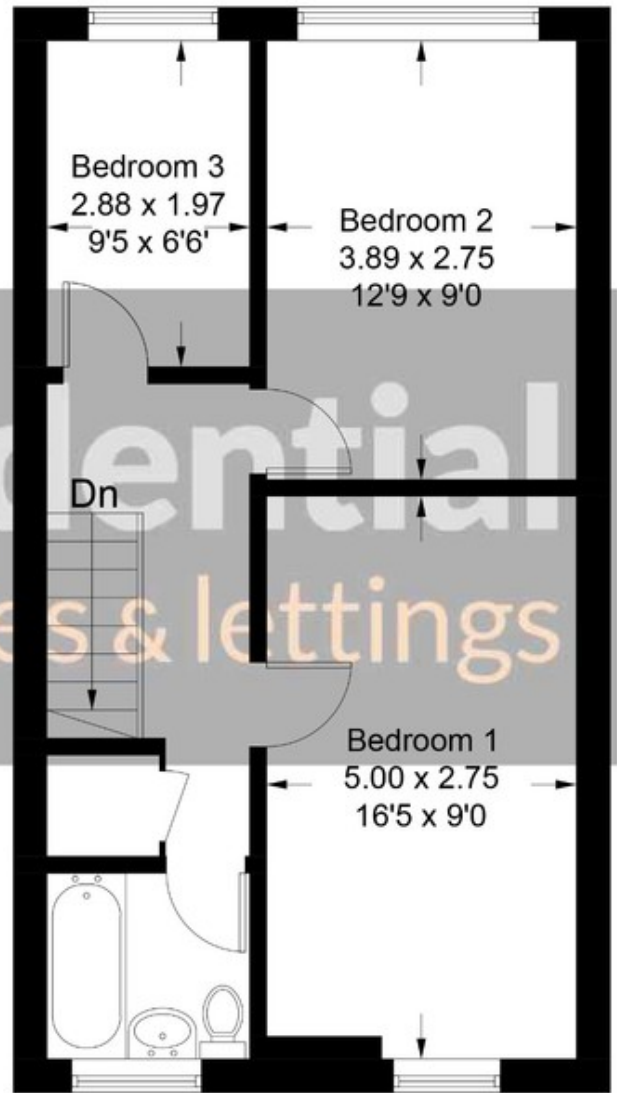

First Floor

Illustration for identification purposes only, measurements are approximate, not to scale. floorplansUsketch.com © (ID639045)

12 Shenley Road, Borehamwood, Hertfordshire, WD6 1DL

T: 020 3617 1333

E: enquiries@laminghope.com