

e sales@laminghope.com
t 020 3617 1333

L&Hresidential
laminghope.com sales & lettings



Clarendon Mews, Borehamwood, WD6

£450,000

- Extended terraced house
- Three bedrooms
- Kitchen/diner
- Two receptions
- Off street parking
- 0.4 miles from Elstree and Borehamwood Train Station
- Short walk to local shops, schools and places of worship
- Unfurnished
- Available move in 2/7/21





L&H Residential are proud to bring to the market this extended terraced house. The accommodation comprises of; three bedrooms, family bathroom, eat in kitchen and two receptions. The property also benefits from its own private garden and off street parking.

Unfurnished
Available move in 2/7/21

An early viewing is advised.

Kitchen

Reception

Dining Room

Bedrooms

Bathroom



Clarendon Mews, Borehamwood, WD6

£450,000

A well presented an extended open plan three bedroom terraced house located just 0.4 miles from Elstree & Borehamwood train station and a short walk to local schools, shops and places of worship.





Clarendon Mews, WD6

Approximate Gross Internal Area = 82.4 sq m / 887 sq ft

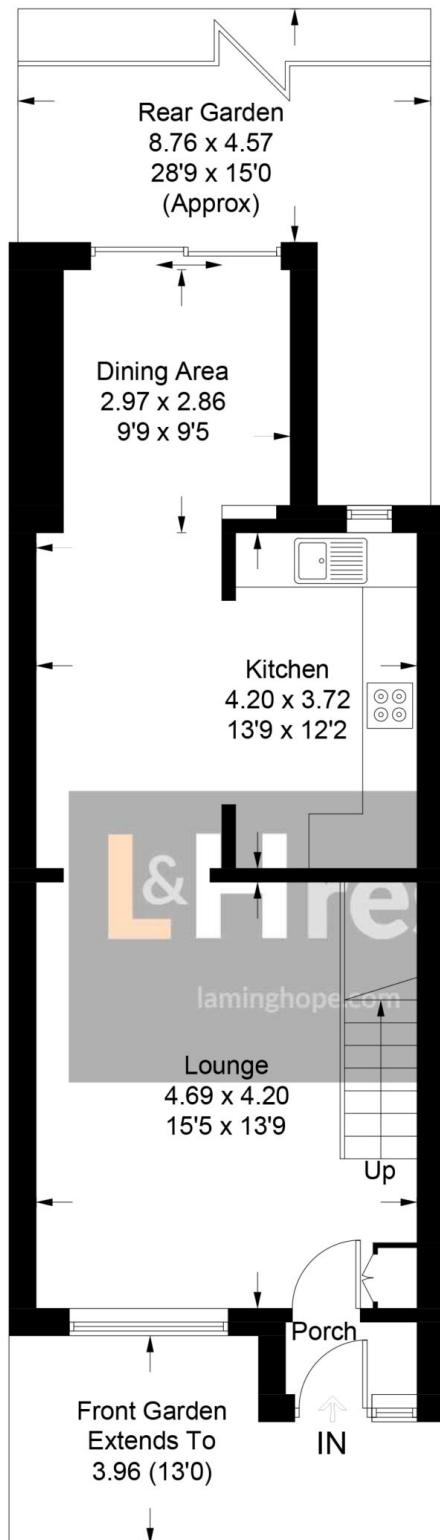

Ground Floor

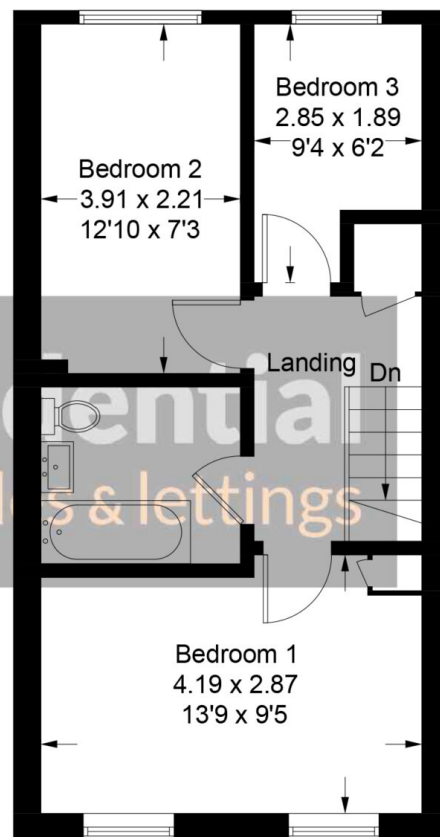

First Floor

Illustration for identification purposes only, measurements are approximate, not to scale. floorplansUsketch.com © (ID748279)

12 Shenley Road, Borehamwood, Hertfordshire, WD6 1DL

T: 020 3617 1333

E: enquiries@laminghope.com