

e sales@laminghope.com
t 020 3617 1333

L&Hresidential
laminghope.com sales & lettings



Corfe Close, WD6

£249,500

- Modern development
- Two bedrooms
- Separate Kitchen
- First floor
- Spacious bathroom with bath and shower
- One mile from Elstree and Borehamwood train station
- South side of Borehamwood
- Short walk to Yavneh College, local shops and bus routes
- Allocated parking space + lots of visitor parking spaces
- CHAIN FREE + VIRTUAL VIEWINGS AVAILABLE





L&H Residential are proud to bring to the market this first floor flat in a modern development located one the South side of Borehamwood, just one mile from Elstree and Borehamwood train station and a short walk to Yavneh College, local shops and bus routes. The accommodation comprises of; two bedrooms, lounge, separate kitchen and spacious bathroom with bath and shower. The property also benefits from an allocated parking space, lots of visitor parking, communal gardens, long lease and being sold CHAIN FREE.

An early viewing is advised



Corfe Close, WD6

£249,500

A two bedroom first floor flat in a modern development on the South side of Borehamwood located just one mile from Elstree and Borehamwood train station with an allocated parking space.



Corfe Close, WD6

Approximate Gross Internal Area = 51.2 sq m / 551 sq ft

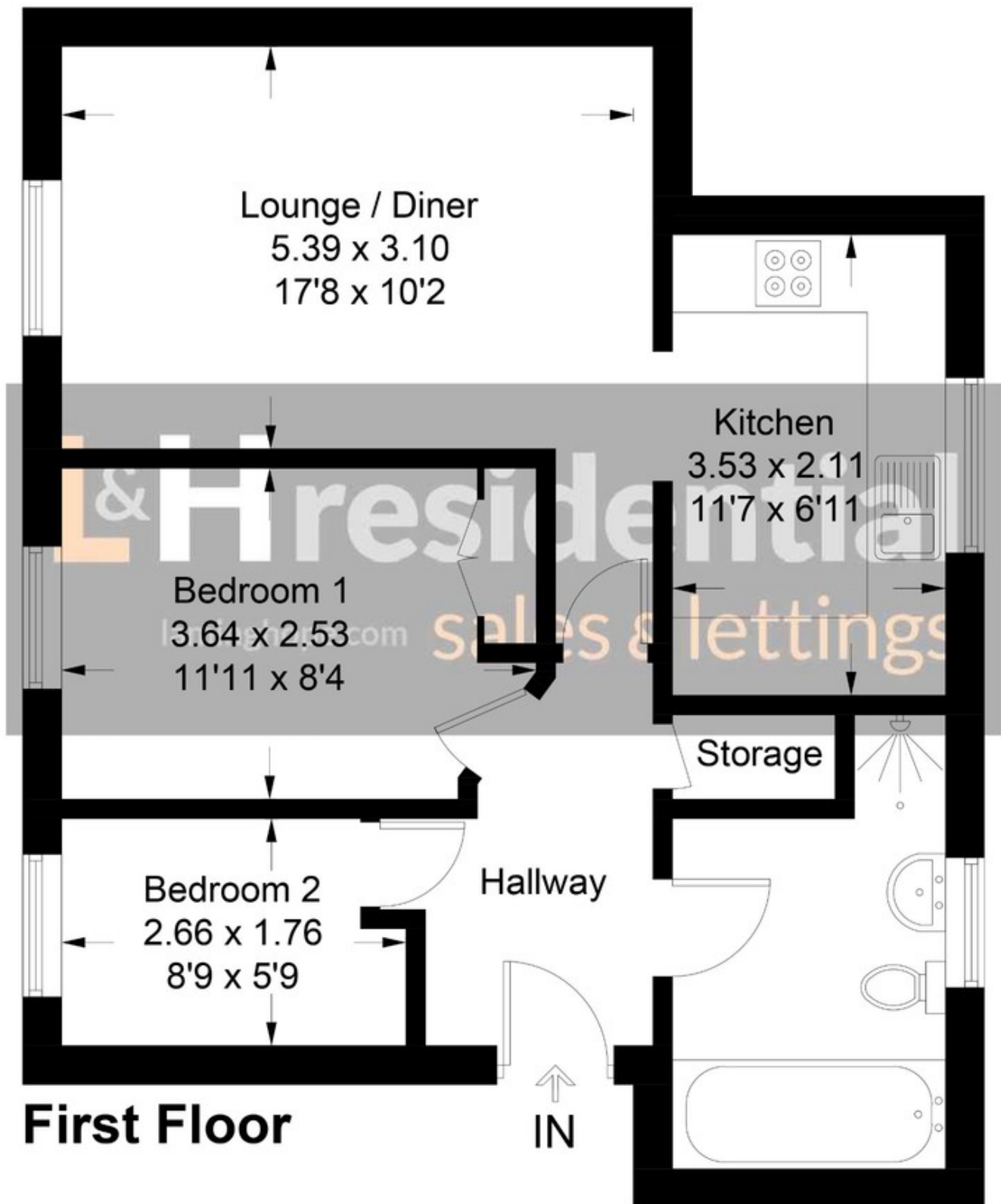

Illustration for identification purposes only, measurements are approximate,
not to scale. floorplansUsketch.com © (ID627839)

12 Shenley Road, Borehamwood, Hertfordshire, WD6 1DL

T: 020 3617 1333

E: enquiries@laminghope.com