

e sales@laminghope.com

t 020 3617 1333

**L&H**residential  
laminghope.com sales & lettings



## Croxdale Road, Borehamwood, WD6

£449,950

- Well presented terraced house
- Two double bedrooms
- Off street parking for two cars
- Southerly facing private garden with side access
- Eat in kitchen
- Downstairs guest WC
- 0.7 miles from Elstree and Borehamwood Train Station
- Short walk to local shops and Synagogue
- CHAIN FREE





L&H Residential are proud to bring to the market this well presented terraced house located just 0.7 miles from Elstree and Borehamwood train station and a short walk to local shops and Synagogue. The accommodation comprises of; two double bedrooms, family bathroom, lounge, eat in kitchen and downstairs guest WC. The property boasts many great features including; off street parking for two cars, 46ft private southerly facing garden with side access and being sold CHIAN FREE.

An early viewing is advised



## Croxdale Road, Borehamwood, WD6

**£449,950**

A well presented two double bedroom terraced house with off street parking located just 0.7 miles from Elstree and Borehamwood train station and a short walk to local shops and Synagogue.





# Croxdale Road, WD6



Approximate Gross Internal Area = 65.4 sq m / 704 sq ft

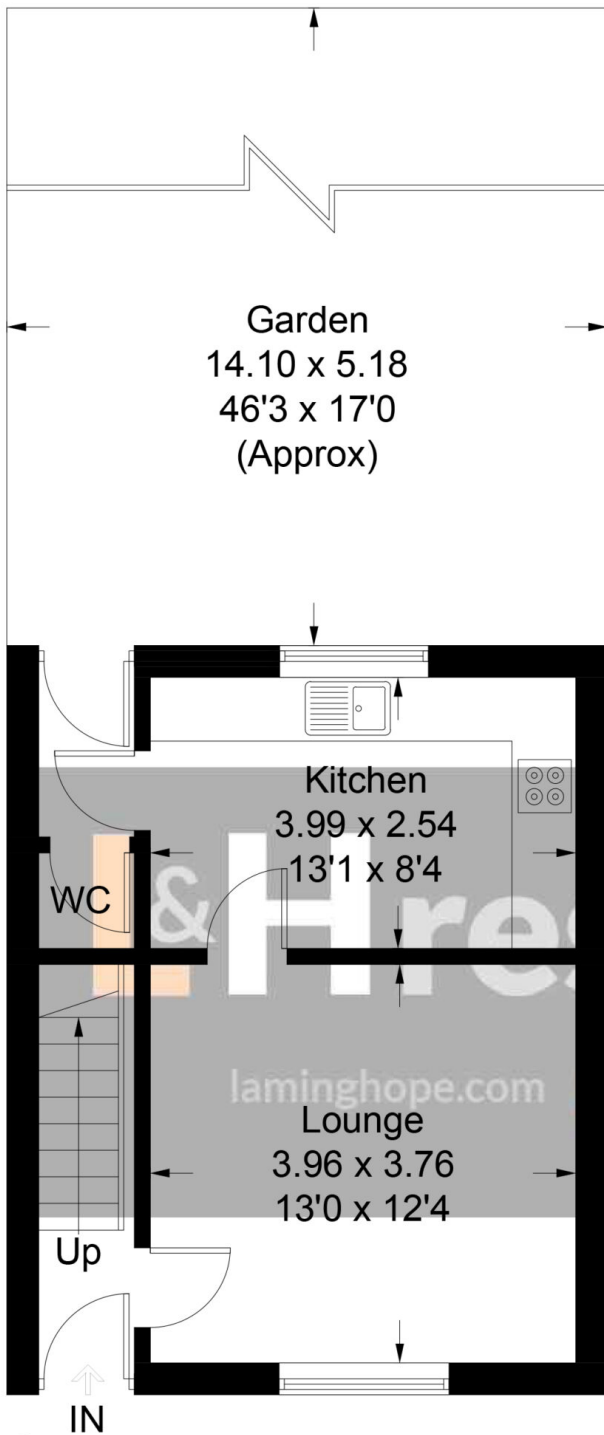

**Ground Floor**

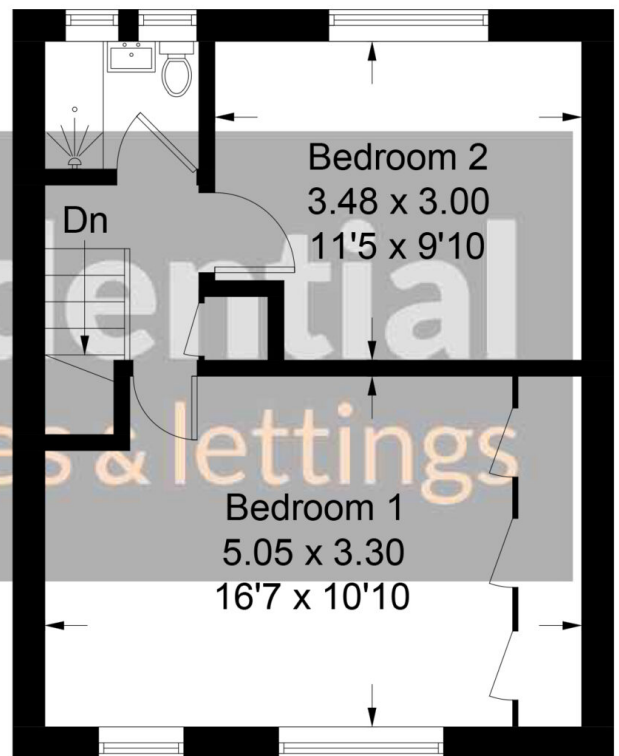

**First Floor**

Illustration for identification purposes only, measurements are approximate, not to scale. floorplansUsketch.com © (ID578270)

12 Shenley Road, Borehamwood, Hertfordshire, WD6 1DL

T: 020 3617 1333

E: [enquiries@laminghope.com](mailto:enquiries@laminghope.com)