

e sales@laminghope.com
t 020 3617 1333

L&Hresidential
laminghope.com sales & lettings



Danziger Way, Borehamwood, WD6

£800 pcm

- First floor flat
- One bedroom
- Off street parking
- Short walk to local schools, shops and places of worship
- Unfurnished
- Move in date 10/2/2022
- SINGLE PERSON OCCUPANCY ONLY





L&H Residential are proud to bring to the market this well presented first floor flat located a short walk from local shops, schools and places of worship. The accommodation comprises of ; bedroom, kitchen/living area and a family bathroom. The property also benefits from having off street parking space.

Unfurnished

SINGLE PERSON OCCUPANCY ONLY

Move in 19/3/2022



Danziger Way, Borehamwood, WD6

£800 pcm

A well presented one bedroom first floor flat with off street parking located a short walk from local schools, shops and places of worship.

Danzinger Way, WD6

Approximate Gross Internal Area = 34 sq m / 366 sq ft

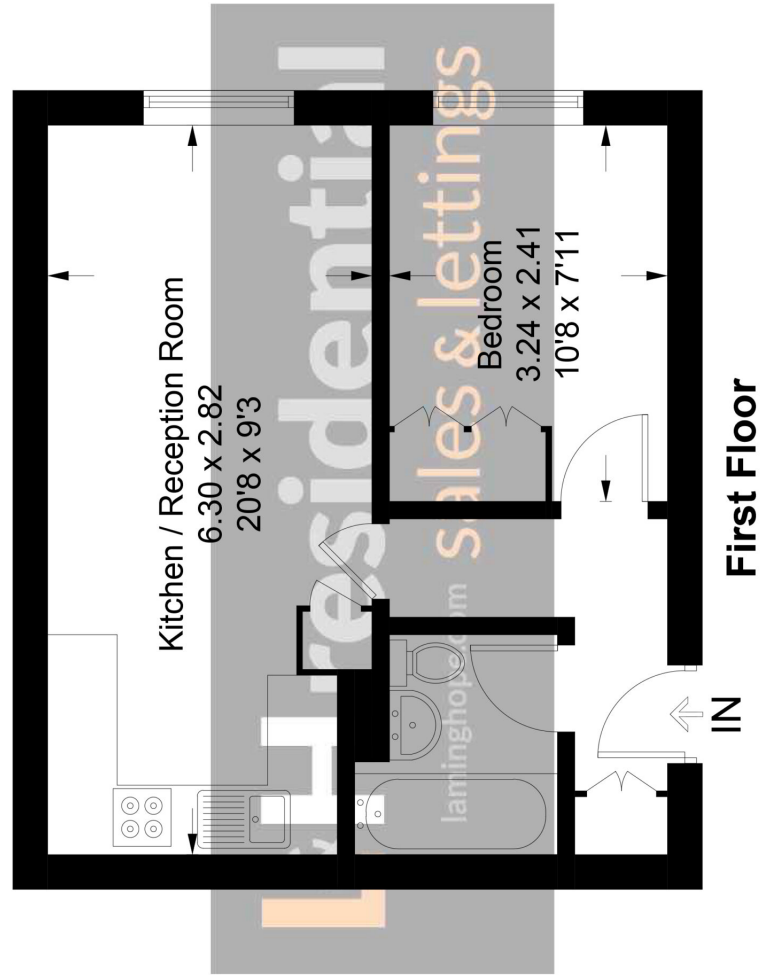

Laminghope

12 Shenley Road, Borehamwood, Hertfordshire, WD6 1DL

T: 020 3617 1333

E: enquiries@laminghope.com

Illustration for identification purposes only. Measurements are approximate, not to scale. floorplansUsketch.com © (ID707653)