

e sales@laminghope.com
t 020 3617 1333

L&Hresidential
laminghope.com sales & lettings



Drayton Road, Nuland Court, WD6

£1,300 pcm

- Beautifully presented ground floor flat
- Two double bedrooms
- Spacious kitchen
- Two allocated parking spaces
- Direct access to communal gardens
- Unfurnished & Available now
- 0.1 miles from Elstree and Borehamwood Train Station





L&H Residential are proud to bring to the market this beautifully presented ground floor modern flat located a stone's throw away from Borehamwood High Street and Elstree and Borehamwood Train Station. The accommodation comprises of; two double bedrooms, kitchen, lounge and family bathroom. The property has many great features such as; built in wardrobes in the master bedroom, two allocated parking spaces and direct access to communal gardens.

Offered unfurnished
Move in now

An early viewing is advised



Drayton Road, Nuland Court, WD6

£1,300 pcm

A modern two double bedroom ground floor flat located just 0.1 miles from Elstree & Borehamwood train station.



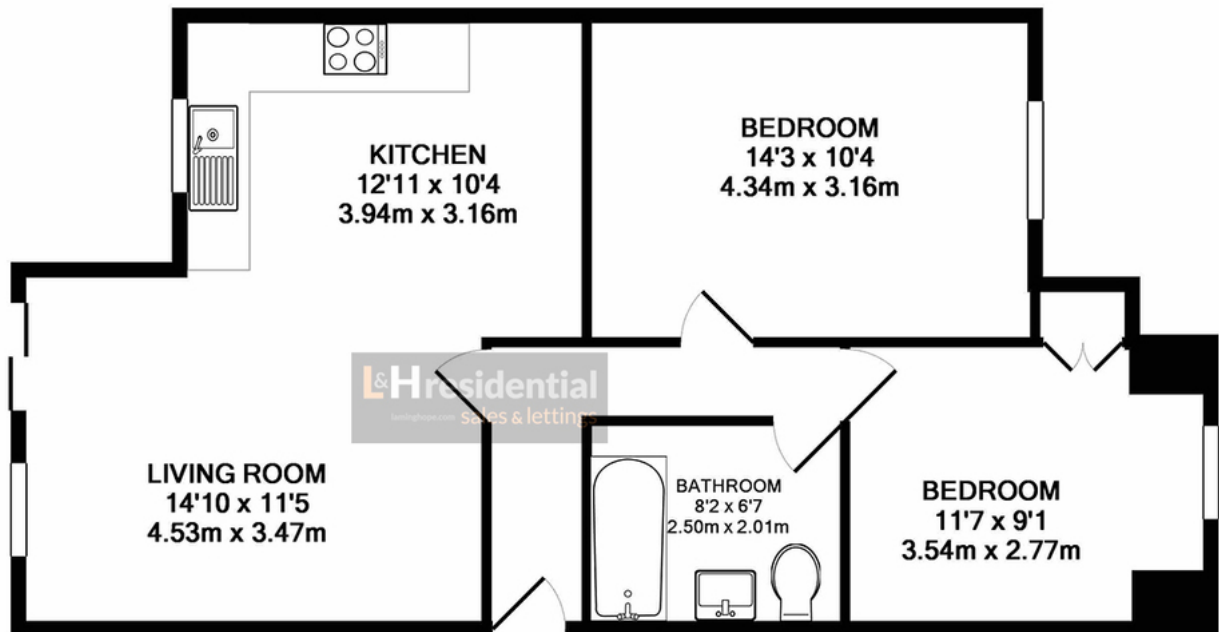

TOTAL APPROX. FLOOR AREA 634 SQ.FT. (58.9 SQ.M.)

Whilst every attempt has been made to ensure the accuracy of the floor plan contained here, measurements of doors, windows, rooms and any other items are approximate and no responsibility is taken for any error, omission, or mis-statement. This plan is for illustrative purposes only and should be used as such by any prospective purchaser. The services, systems and appliances shown have not been tested and no guarantee as to their operability or efficiency can be given

Made with Metropix ©2017



Laminghope

12 Shenley Road, Borehamwood, Hertfordshire, WD6 1DL

T: 020 3617 1333

E: enquiries@laminghope.com