

e sales@laminghope.com

t 020 3617 1333

L&Hresidential
laminghope.com sales & lettings



Drayton Road, WD6

£1,250 pcm

- First floor maisonette
- Three double bedrooms
- Kitchen/diner
- Own private entrance
- Yavneh College catchment
- 0.2 miles from Elstree and Borehamwood Train Station
- Furnished/Part Furnished
- Move in date 10/09/2018





L&H Residential are proud to bring onto the market this well presented first floor maisonette located a stone's throw away from Borehamwood High Street and Elstree and Borehamwood Train Station. The accommodation comprises of; three double bedrooms, kitchen/diner, lounge and family bathroom. The property has many great features as well as being excellently located for the local amenities and transport, it is; in the catchment area for Yavneh College and has its own private entrance.

An early viewing is advised
 Furnished/ Part Furnished
 Move in date 10/9/18



Drayton Road, WD6

£1,250 pcm

A three bedroom first floor maisonette.

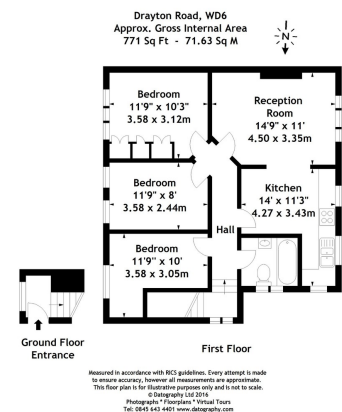

3 Penta Court, Station Road, Borehamwood, Hertfordshire, WD6 1SL

T: 020 3617 1333

E: enquiries@laminghope.com