

e sales@laminghope.com
t 020 3617 1333

L&Hresidential
laminghope.com sales & lettings



Franklin Court, Brook Road, WD6

£375,000

- Recently built (2018)
- 6th floor flat with lift
- Two double bedrooms (800sqft)
- Open plan living space
- Secure underground parking space
- 0.6 miles from Elstree and Borehamwood train station
- Communal gardens
- Abundance of natural light
- Long lease
- CHAIN FREE





L&H Residential are proud to bring onto the market this recently built and spacious flat located just 0.6 miles from Elstree and Borehamwood train station and a short walk to local amenities schools and places of worship. The accommodation comprises of; two double bedrooms, bathroom and open plan kitchen/living area. The property has many great features as well as being excellently located it has; a secure underground parking space, lift, communal gardens, an abundance of natural light, long lease and being sold CHAIN FREE.

An early viewing is advised



Franklin Court, Brook Road, WD6

£375,000

A spacious and recently built (2018) two double bedroom sixth floor flat with secure underground parking and located just 0.6 miles from Elstree and Borehamwood train station.





Franklin Court, WD6

Approx. Gross Internal Area
800 Sq Ft - 74.28 Sq M

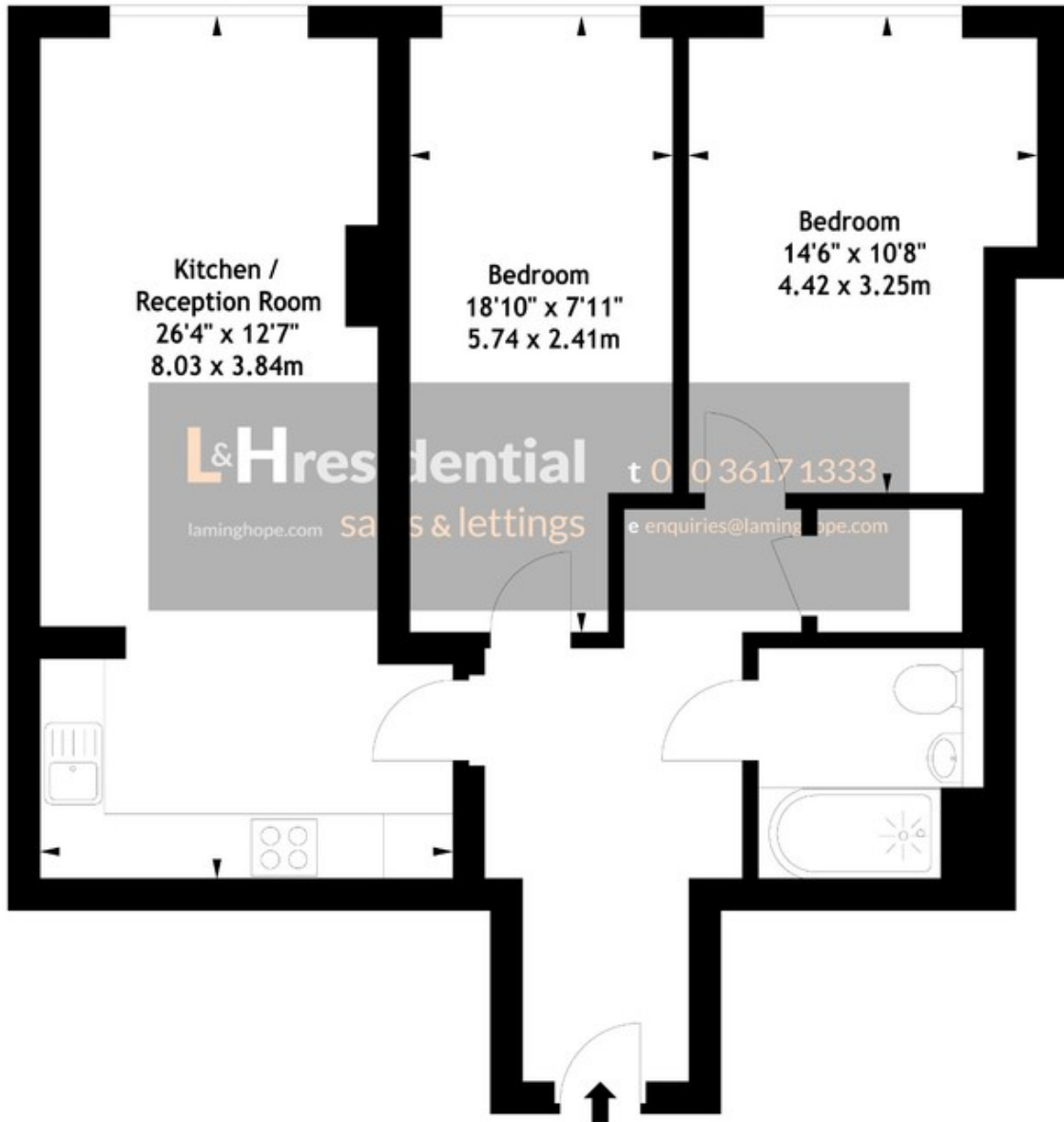

Sixth Floor

This plan is for layout guidance only. Not drawn to scale unless stated.

Windows & door openings are approximate. Whilst every care is taken in the preparation of this plan, please check all dimensions, shapes & compass bearings before making any decisions reliant upon

Laminghope

12 Shenley Road, Borehamwood, Hertfordshire, WD6 1DL

T: 020 3617 1333

E: enquiries@laminghope.com