

e sales@laminghope.com  
t 020 3617 1333

**L&H**residential  
laminghope.com sales & lettings



## Franklin Court, Brook Road, WD6

**£375,000**

- Recently built (2018)
- 6th floor flat with lift
- Two double bedrooms (800sqft)
- Open plan living space
- Secure underground parking space
- 0.6 miles from Elstree and Borehamwood train station
- Communal gardens
- Abundance of natural light
- Long lease
- CHAIN FREE





L&H Residential are proud to bring onto the market this recently built and spacious flat located just 0.6 miles from Elstree and Borehamwood train station and a short walk to local amenities schools and places of worship. The accommodation comprises of; two double bedrooms, bathroom and open plan kitchen/living area. The property has many great features as well as being excellently located it has; a secure underground parking space, lift, communal gardens, an abundance of natural light, long lease and being sold CHAIN FREE.

An early viewing is advised



## Franklin Court, Brook Road, WD6

**£375,000**

A spacious and recently built (2018) two double bedroom sixth floor flat with secure underground parking and located just 0.6 miles from Elstree and Borehamwood train station.







## Franklin Court, WD6

Approx. Gross Internal Area  
800 Sq Ft - 74.28 Sq M

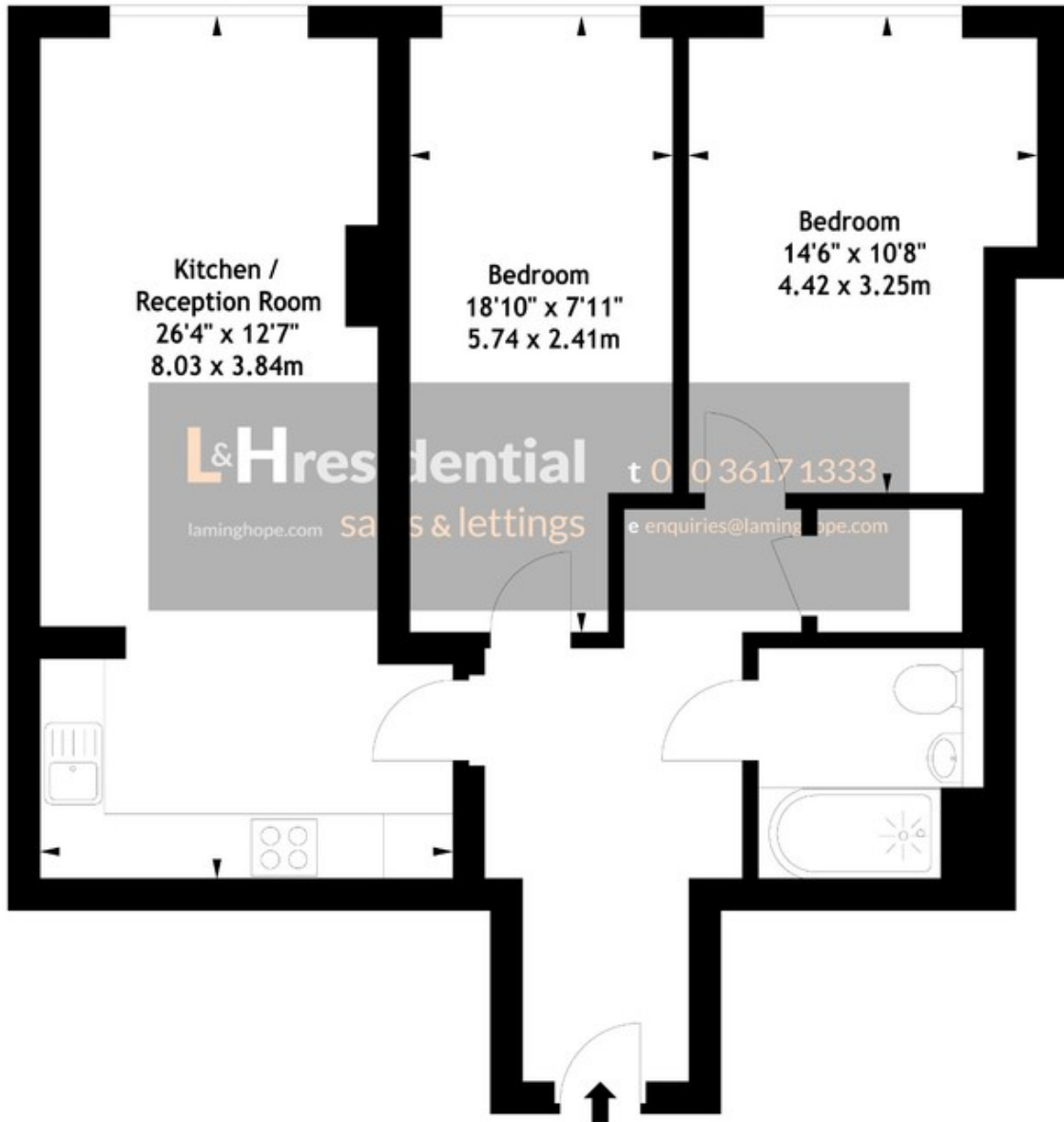

### Sixth Floor

This plan is for layout guidance only. Not drawn to scale unless stated.

Windows & door openings are approximate. Whilst every care is taken in the preparation of this plan, please check all dimensions, shapes & compass bearings before making any decisions reliant upon

**Laminghope**

12 Shenley Road, Borehamwood, Hertfordshire, WD6 1DL

T: 020 3617 1333

E: [enquiries@laminghope.com](mailto:enquiries@laminghope.com)