

e sales@laminghope.com  
t 020 3617 1333

**L&H**residential  
laminghope.com sales & lettings



## Horizon Place, Studio Way, WD6

£1,150 pcm

- Recently built second floor one bedroom flat
- Modern open plan living
- Two southerly facing balconies
- Lift
- Communal garden
- Allocated parking space
- Short walk to local shops and bus routes
- Lots of storage
- One mile from Borehamwood and Elstree train station
- Unfurnished + Available now





L&H residential are proud to bring to the market this ultra modern and spacious second floor flat located just one mile from Elstree and Borehamwood train station and a short walk to local shops, bus routes and amenities. The accommodation comprises of; a double bedroom, bathroom and a spacious open plan kitchen/living area. As well as being excellently located the property has other great features including; an allocated parking space, two southerly facing balconies, lift, lots of storage and use of a communal garden.

Unfurnished + Available now

An early viewing is advised



## Horizon Place, Studio Way, WD6

**£1,150 pcm**

A recently built and ultra modern second floor one bedroom flat with two southerly facing balconies, lift and an allocated parking space.







## Horizon Place, Studio Way, WD6

Approximate Gross Internal Area = 48 sq m / 514 sq ft

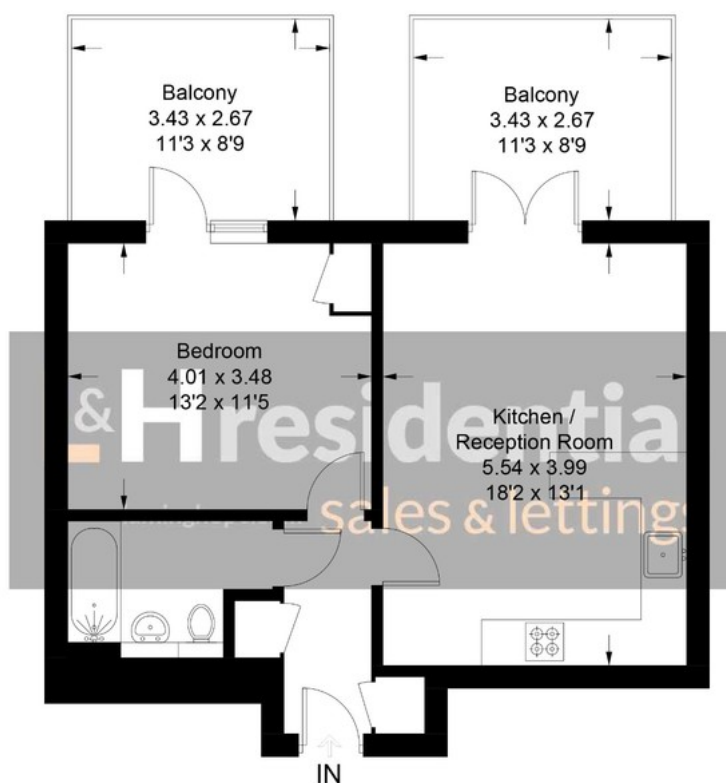

Illustration for identification purposes only, measurements are approximate,  
not to scale. floorplansUsketch.com © (ID692897)

### Laminghope

12 Shenley Road, Borehamwood, Hertfordshire, WD6 1DL

T: 020 3617 1333

E: [enquiries@laminghope.com](mailto:enquiries@laminghope.com)