

e sales@laminghope.com
t 020 3617 1333

L&Hresidential
laminghope.com sales & lettings



Leeming Road, Borehamwood, WD6

£265,000

- Ground and first floor maisonette
- Three bedrooms
- Eat in kitchen
- CHAIN FREE
- Private own entrance
- Private front and back garden
- 0.9 miles from Elstree & Borehamwood train station
- In need of modernisation

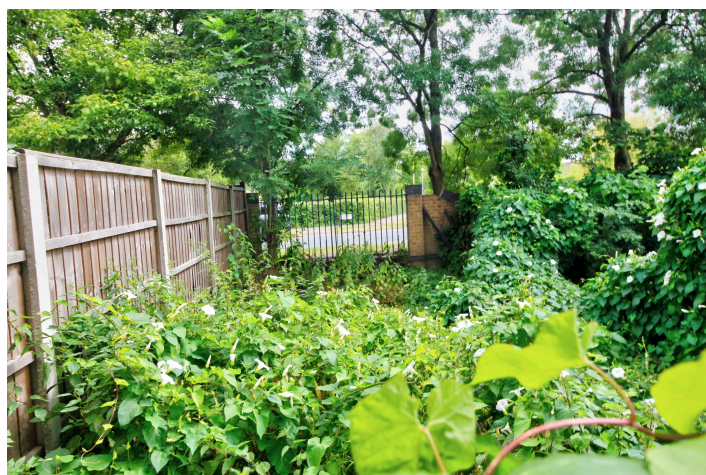

L&H Residential are proud to bring to the market this uniquely spacious ground floor and first floor maisonette (in need of modernisation) located 0.9 miles from Elstree & Borehamwood train station and a short walk to local shops, schools, Aberford park and public transport. The accommodation comprises of three bedrooms, family bathroom, eat in kitchen and a reception room. The property boasts many great features including; own private entrance, private front and rear garden and being sold CHAIN FREE.

An early viewing is advised

Leeming Road, Borehamwood, WD6

£265,000

A spacious duplex three bedroom ground floor and first floor maisonette with own front and rear garden located just 0.9 miles from Elstree & Borehamwood train station and a short walk to local shops, schools, Aberford park and bus routes.

Rear Garden 25' Approx

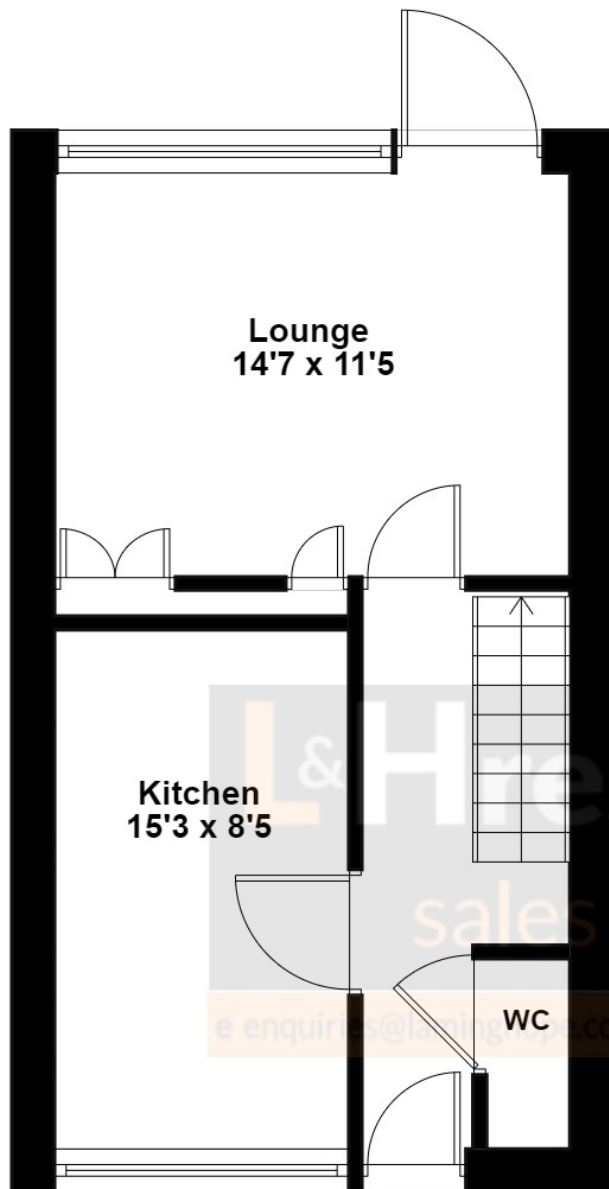

Front Garden

Ground Floor

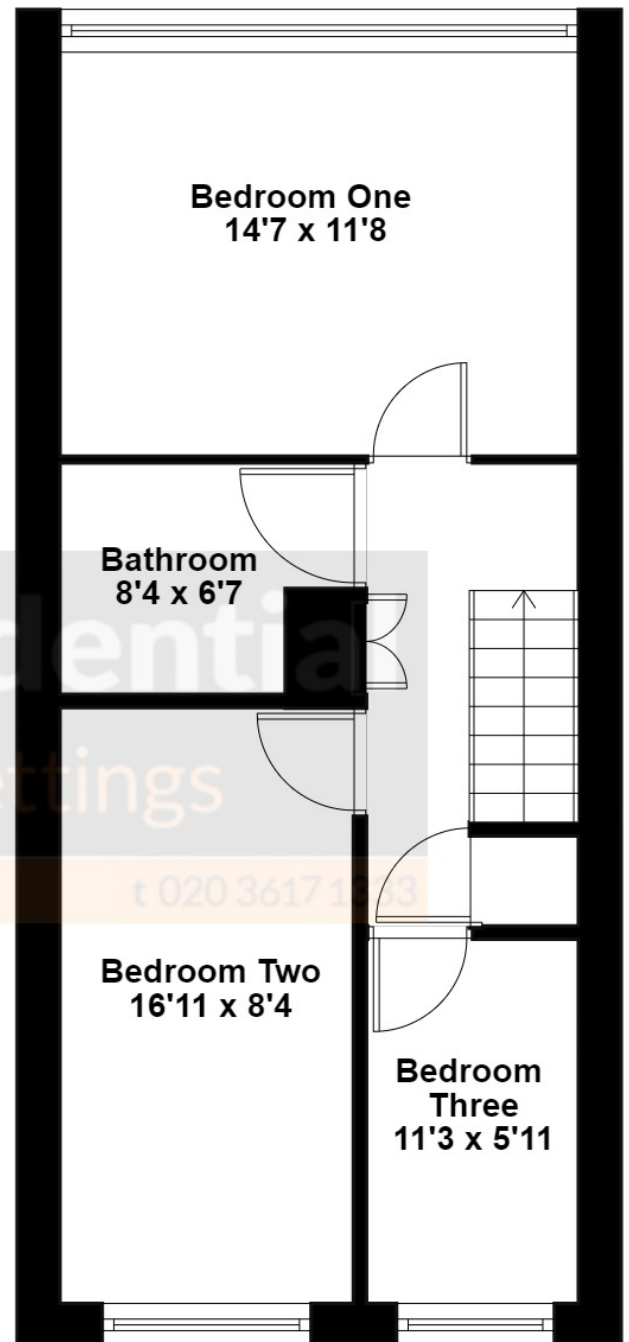

First Floor

Total Floor Area Approx 854ft² (79.15m²)
364ft² (33.82m²) Ground Floor
490ft² (45.52m²) First Floor

12 Shenley Road, Borehamwood, Hertfordshire, WD6 1DL

T: 020 3617 1333

E: enquiries@laminghope.com