

e sales@laminghope.com
t 020 3617 1333

L&Hresidential
laminghope.com sales & lettings



Leeming Road, Borehamwood, WD6

£275,000

- Two double bedroom ground floor and first floor maisonette
- Own front and back garden with direct access from property
- Eat in kitchen
- Private own entrance
- 0.9 miles from Elstree and Borehamwood train station
- CHAIN FREE





L&H Residential are proud to bring to the market this uniquely spacious ground floor and first floor maisonette located 0.9 miles from Elstree & Borehamwood train station and a short walk to local shops, schools, Aberford park and public transport. The accommodation comprises of two double bedrooms, family bathroom with separate W.C, eat in kitchen and a reception room. The property boasts many great features including; own private entrance, private front and rear garden and being sold CHAIN FREE.

An early viewing is advised



Leeming Road, Borehamwood, WD6

£275,000

A spacious duplex two double bedroom ground floor and first floor maisonette with own front and rear garden located just 0.9 miles from Elstree & Borehamwood train station and a short walk to local shops, schools, Aberford park and bus routes.





Milby court, Leeming Road, WD6

Approximate Gross Internal Area = 74.9 sq m / 806 sq ft

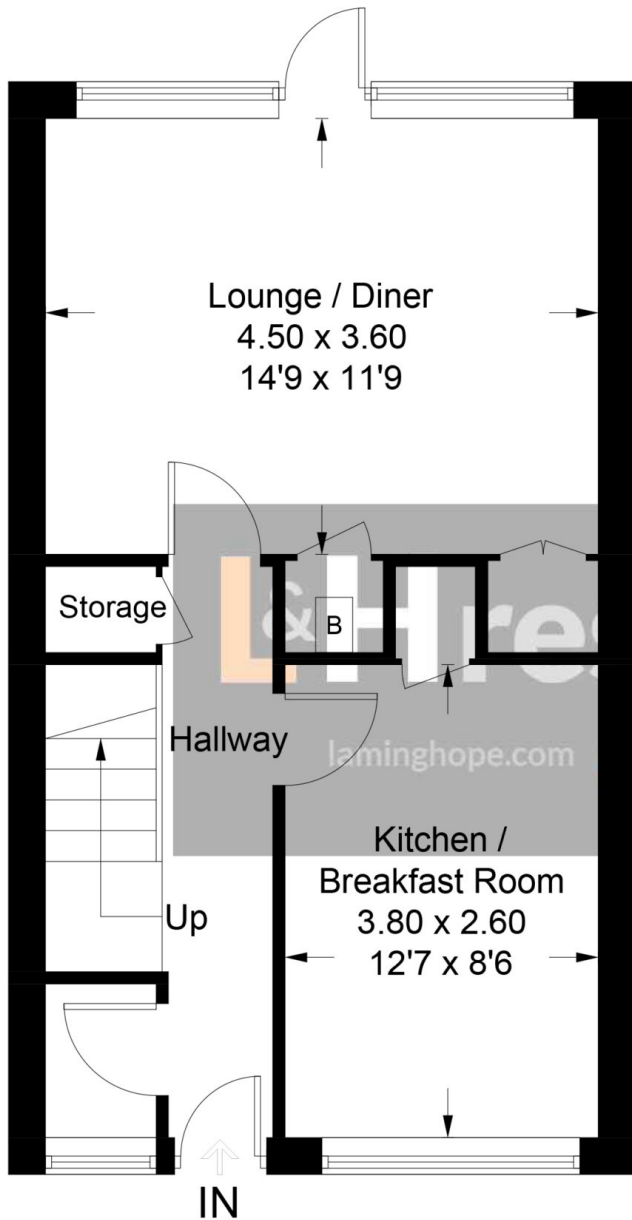

Ground Floor

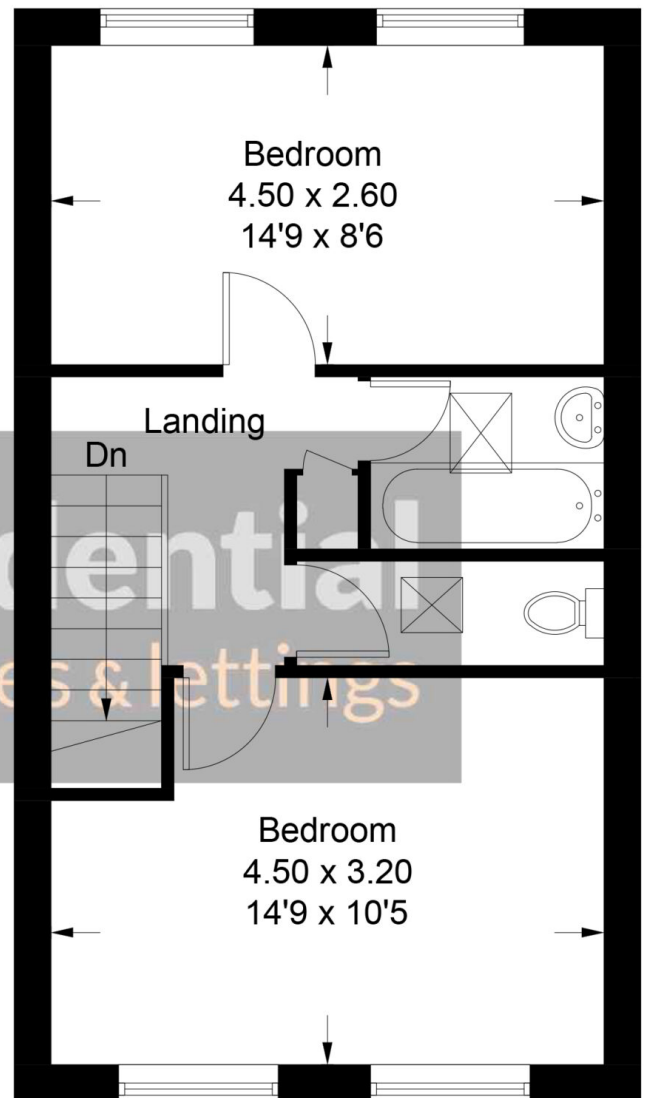

First Floor

Illustration for identification purposes only, measurements are approximate,
not to scale. floorplansUsketch.com © (ID842262)

12 Shenley Road, Borehamwood, Hertfordshire, WD6 1DL

T: 020 3617 1333

E: enquiries@laminghope.com