

e sales@laminghope.com
t 020 3617 1333

L&Hresidential
laminghope.com sales & lettings



Little Hays, Borehamwood, WD6

£4,200 pcm

- New built semi detached house built by Griggs to a high specification
- Three double bedrooms
- Two bathrooms
- Eat in kitchen & Two receptions
- Downstairs guest W.C.
- Off street parking
- Available Immediately & Unfurnished





L&H residential are pleased to present this exquisite, newly built 3-bedroom semi-detached house crafted with precision and high-quality finishes by Griggs. Boasting three generous double bedrooms, two well-appointed bathrooms, an attractive eat-in kitchen, and two receptions, this property offers an abundance of space for comfortable living. The ground floor features a convenient guest W.C., perfect for hosting guests. In addition, off-street parking adds to the practicality of this residence. This charming property is available immediately and is offered unfurnished, providing a blank canvas for you to make it your own. Situated in a desirable location, this semi-detached house offers modern living at its finest. Don't miss the opportunity to make this property your home sweet home. Contact us today to arrange a viewing before it's gone!



Little Hays, Borehamwood, WD6

£4,200 pcm

Exquisite 3-bed semi-detached house by Griggs, with high-quality finishes. Features 3 double bedrooms, 2 bathrooms, eat-in kitchen, 2 receptions, guest WC, off-street parking. Available unfurnished in desirable location for modern living. Book a viewing today!



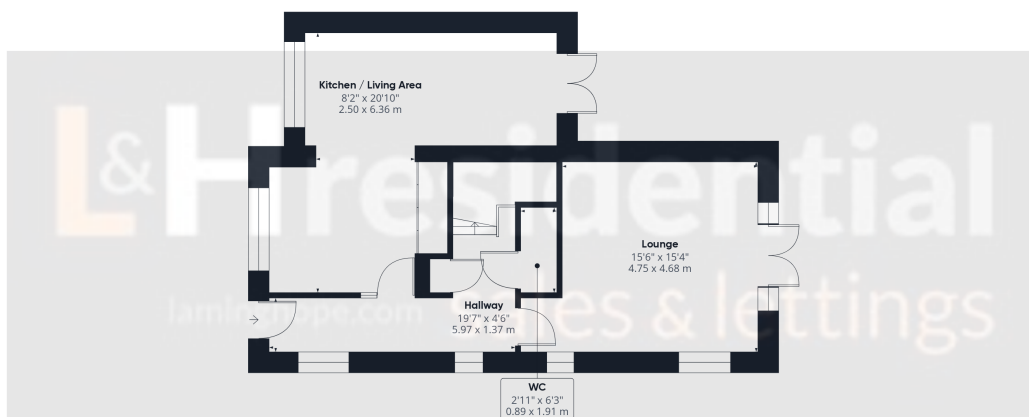

Ground Floor

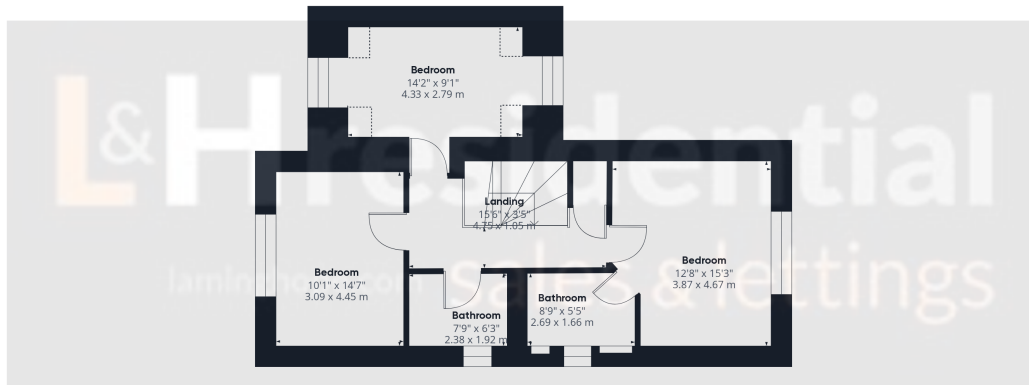

Floor 1

Approximate total area⁽¹⁾

1447.97 ft²

134.52 m²

Reduced headroom

183.09 ft²

1.58 m²

(1) Excluding balconies and terraces

Reduced headroom

----- Below 5 ft/1.5 m

While every attempt has been made to ensure accuracy, all measurements are approximate, not to scale. This floor plan is for illustrative purposes only. Calculations are based on RICS IPMS 3C standard.

GIRAFFE360

Laminghope

12 Shenley Road, Borehamwood, Hertfordshire, WD6 1DL

T: 020 3617 1333

E: enquiries@laminghope.com