

e sales@laminghope.com
t 020 3617 1333

L&Hresidential
laminghope.com sales & lettings



Sinderby Close, Borehamwood, WD6

£2,400 pcm

- Stunningly presented end of terrace house (1690sqft)
- Four double bedrooms
- Three bathrooms (one on ground floor)
- Spacious Kitchen/breakfast room
- 21ft living room
- Utility room/playroom
- Underfloor heating throughout ground floor
- Large private garden
- Short walk to local schools, shops, park and bus routes.

L&Hresidential
laminghope.com sales & lettings

- Furnished & Available 2/5/22



L&H Residential are proud to bring to the market this stunning recently extended and refurbished end of terraced house (1690sqft) located a short walk to local schools, shops, park and bus routes. The accommodation comprises of; four double bedrooms, three bathrooms (one on ground floor), utility room/play room, spacious lounge and an ultra-contemporary kitchen/breakfast room. The property boasts many great features such; underfloor heating throughout ground floor and a large private garden.

Furnished & Available 2/5/22

An early viewing is advised



**Sinderby Close,
Borehamwood, WD6**

£2,400 pcm

A stunningly presented four double bedroom three bathroom end of terraced house located a short walk to local schools, shops, park and bus routes.



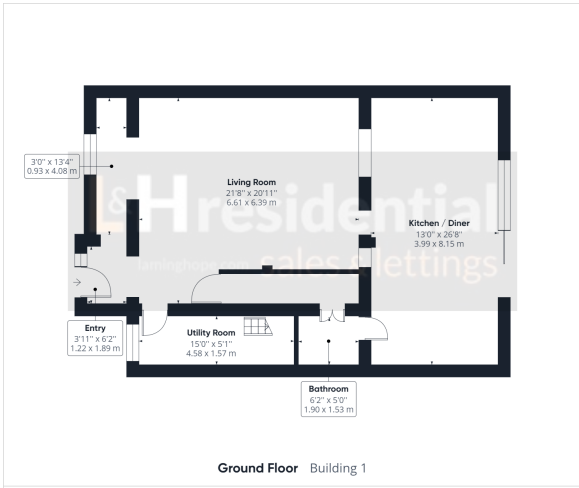

<p>Approximate total area⁽¹⁾</p> <p>1694.90 ft² 157.46 m²</p> <p>Reduced headroom</p> <p>33.86 ft² 3.15 m²</p>
(1) Excluding balconies and terraces
<p>⌚ Reduced headroom (below 1.5m/4.92ft)</p>
<p>While every attempt has been made to ensure accuracy, all measurements are approximate, not to scale. This floor plan is for illustrative purposes only.</p> <p>GIRAFFE360</p>

Laminghope

12 Shenley Road, Borehamwood, Hertfordshire, WD6 1DL

T: 020 3617 1333

E: enquiries@laminghope.com