

e sales@laminghope.com

t 020 3617 1333

**L&H**residential  
laminghope.com sales & lettings



## Siskin Close, Borehamwood, WD6

£995 pcm

- One bedroom
- End of terrace house
- Allocated parking space
- 0.1 miles from Elstree and Borehamwood Train Station
- Available 3/9/20
- Unfurnished
- Open plan kitchen/living space
- Front garden





L&H Residential are proud to bring onto the market this well presented end of terrace house located within 0.1 miles of Elstree and Borehamwood Train Station and a two minute walk to the High Street. The accommodation comprises of; open plan kitchen living area on the ground floor and a spacious bedroom and bathroom on the first floor. The property also has the added benefit of an allocated parking space and a front garden.

The property is being offered unfurnished  
 Move in 3/9/20  
 ?An early viewing is advised



# Siskin Close, Borehamwood, WD6

£995 pcm

A well presented one bedroom end of terrace house

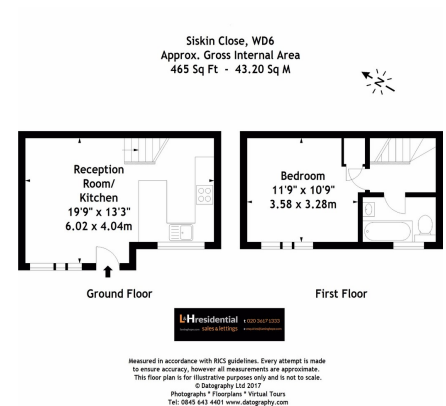

**Laming Hope Residential**

3 Penta Court, Station Road, Borehamwood, Hertfordshire, WD6 1SL

T: 020 3617 1333

E: enquiries@laminghope.com