

e sales@laminghope.com
t 020 3617 1333

L&Hresidential
laminghope.com sales & lettings



Tallis Way, Borehamwood, WD6

£400,000

- Terraced townhouse (1173sqft)
- Three bedrooms
- Integral garage (potential to convert) + Utility room
- Kitchen/diner
- Off street parking for two cars
- Private garden
- Downstairs guest W.C
- Short walk to local shops, schools and bus routes
- Potential to extend (stpp)

- CHAIN FREE



L&H Residential are proud to bring to the market this spacious terraced townhouse located a short walk to local schools, shops and bus routes. The accommodation comprises of; three bedrooms, family bathroom, reception , kitchen/diner, utility room, garage (potential to convert) and a downstairs guest W.C. As well as being excellently located the property also benefits from; off street parking for two cars, private garden, potential to extend (stpp) and being sold CHAIN FREE., shops and bus routes. The accommodation comprises of; three bedrooms, family bathroom, reception , kitchen/diner, utility room, garage (potential to convert) and a downstairs guest W.C. As well as being excellently located the property also benefits from; off street parking for two cars, private garden, potential to extend (stpp) and being sold CHAIN FREE.

Kitchen

Lounge

Bathroom

Bedrooms



Tallis Way, Borehamwood, WD6

£400,000

A well presented three bedroom townhouse with off street parking located a short walk to local shops, schools and bus routes.



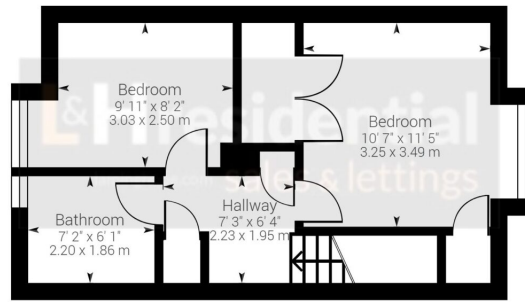

2nd Floor

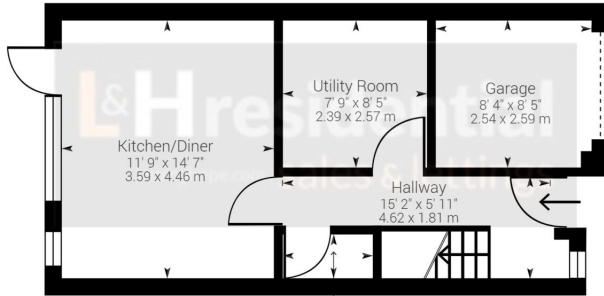

Ground Floor

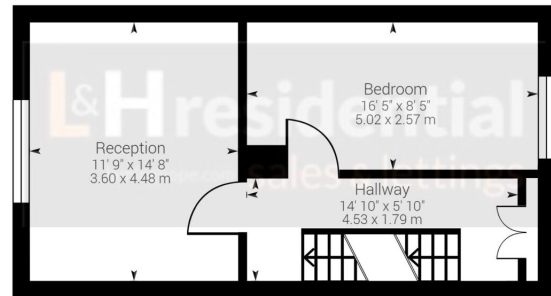

1st Floor

Approximate net internal area: 1098.14 ft² (1173.39 ft²) / 102.02 m² (109.01 m²)

While every attempt has been made to ensure accuracy, all measurements are approximate, not to scale. This floor plan is for illustrative purpose only and should be used as such by any prospective tenant or purchaser.

Powered by Giraffe360

Laminghope

12 Shenley Road, Borehamwood, Hertfordshire, WD6 1DL

T: 020 3617 1333

E: enquiries@laminghope.com