

e sales@laminghope.com
t 020 3617 1333

L&Hresidential
laminghope.com sales & lettings



Todd Close, Borehamwood, WD6

£310,000

- Modern ground floor flat
- Two bedrooms
- Open plan kitchen/diner
- Direct access to communal gardens
- Use of communal roof terrace
- Allocated parking space
- Share of Freehold
- 0.9 miles from Elstree and Borehamwood train station
- CHAIN FREE





L&H Residential are proud to bring to the market this well presented and modern ground floor flat located just 0.9 miles from Elstree and Borehamwood train station and a short walk to local amenities and town centre. The accommodation comprises of; two bedrooms, modern kitchen open plan to lounge and a family bathroom. As well as being excellently located the property has other great features including; direct access to communal gardens, communal roof terrace, share of freehold, an allocated parking space and being sold CHAIN FREE.

An early viewing is advised



Todd Close, Borehamwood, WD6

£310,000

A modern two bedroom ground floor flat with direct access to communal gardens located just 0.9 miles from Elstree & Borehamwood train station.



Taylor Court, Todd Close, WD6

Approximate Gross Internal Area = 48 sq m / 517 sq ft

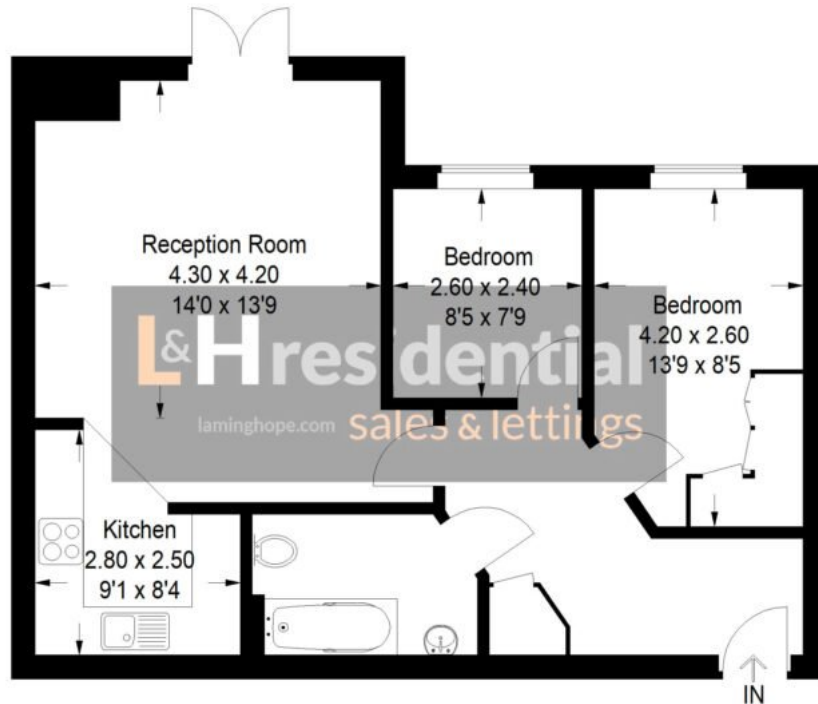

Illustration for identification purposes only, measurements are approximate, not to scale.
FloorplansUsketch.com © 2022 (ID849220)

Laminghope

12 Shenley Road, Borehamwood, Hertfordshire, WD6 1DL

T: 020 3617 1333

E: enquiries@laminghope.com