

e sales@laminghope.com
t 020 3617 1333

L&Hresidential
laminghope.com sales & lettings



Torworth Road, Borehamwood, WD6

£375,000

- Terraced house
- Two double bedrooms
- Two receptions
- Downstairs guest W.C.
- Potential to convert first floor to three bedrooms with minimal adjustments
- Potential to add driveway (stpp)
- Private garden with side access
- Overlooking Aycliffe park
- Short walk to local shops, schools and bus routes





L&H Residential are proud to bring to the market this well presented terraced house located a short walk from local schools, shops and bus routes. The accommodation comprises of; two double bedrooms, family bathroom, kitchen/diner, downstairs guest W.C and two receptions. The property boasts other great features such as; private garden with side access, first floor can be converted into three bedrooms with minimal building work, potential to add driveway (stpp) and overlooks Aycliffe park.

An early viewing is advised



Torworth Road, Borehamwood, WD6

£375,000

A well presented two double bedroom terraced house located a short walk from local schools, shops and bus routes.



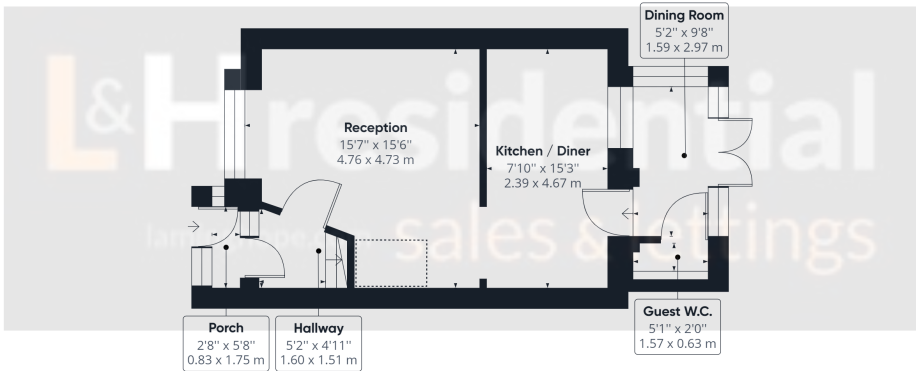

Ground Floor Building 1

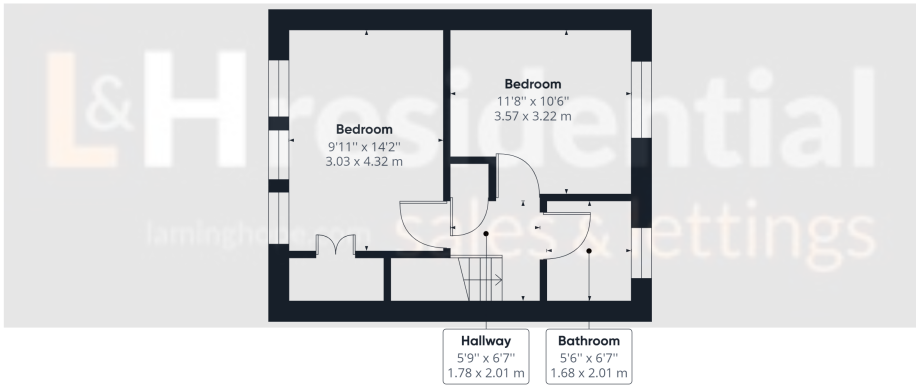

Floor 1 Building 1

Approximate total area⁽¹⁾
 794.14 ft²
 73.78 m²

Reduced headroom
 13.76 ft²
 1.28 m²

(1) Excluding balconies and terraces

Reduced headroom
 (below 1.5m/4.92ft)

While every attempt has been made to ensure accuracy, all measurements are approximate, not to scale. This floor plan is for illustrative purposes only.

GIRAFFE360

Laminghope
 12 Shenley Road, Borehamwood, Hertfordshire, WD6 1DL
 T: 020 3617 1333
 E: enquiries@laminghope.com