

e sales@laminghope.com
t 020 3617 1333

L&Hresidential
laminghope.com sales & lettings



Torworth Road, Borehamwood, WD6

£950 pcm

- Ground floor flat
- One bedroom
- Direct access to own private garden
- Unfurnished





L&H Residential are proud to bring to the market this spacious and well presented ground floor flat located a short walk from the local shops and transport. The accommodation comprises of a bedroom, kitchen, lounge and family bathroom. As well as being excellently located the property benefits from having direct access to its own private garden.

?An early viewing is advised

Unfurnished
Available now



Torworth Road, Borehamwood, WD6

£950 pcm

A spacious and well presented ground floor flat with direct access to own private garden

Torworth Road, WD6

Approximate Gross Internal Area = 50.9 sq m / 548 sq ft

Storage = 1.8 sq m / 19 sq ft

Total = 52.7 sq m / 567 sq ft

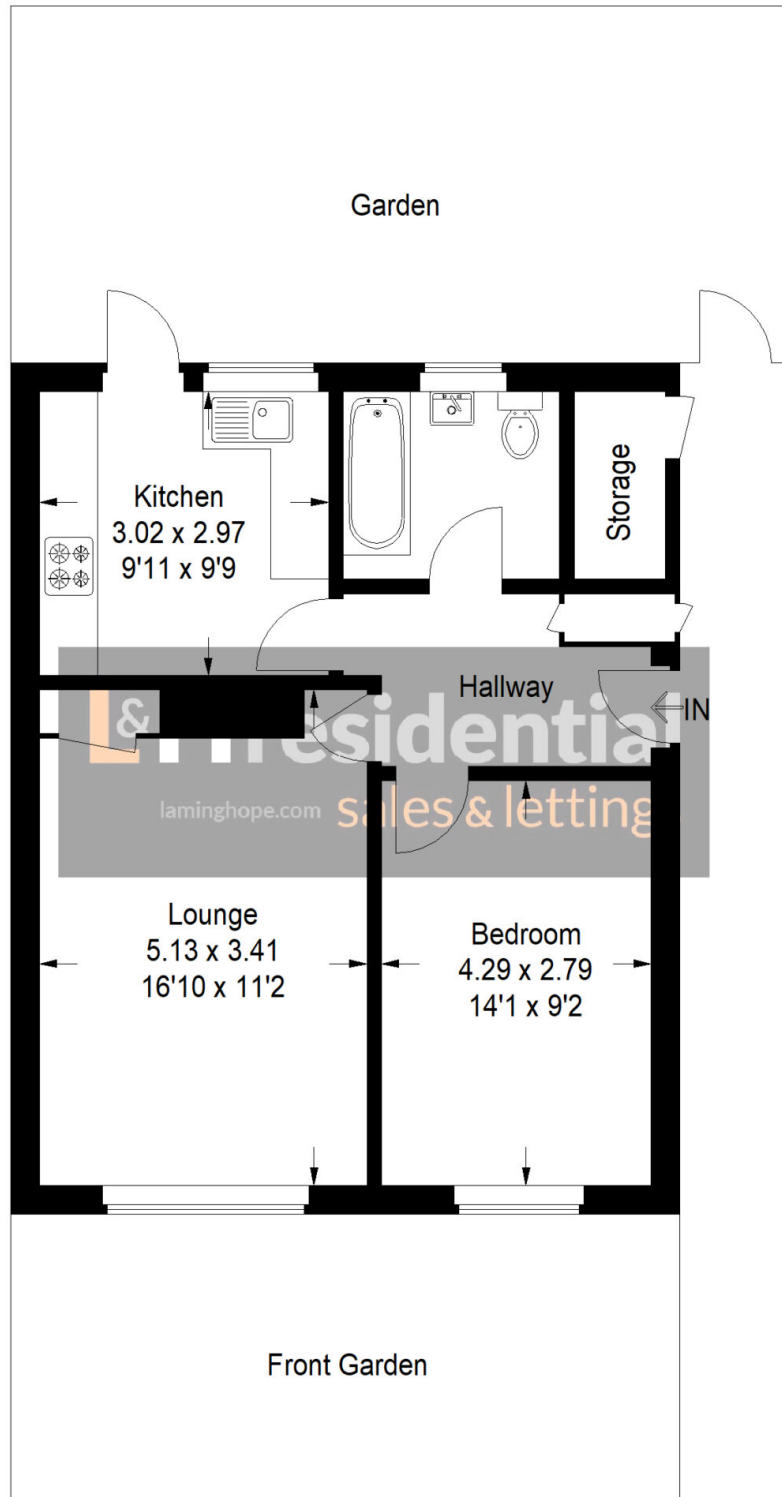

Ground Floor

Illustration for identification purposes only,
measurements are approximate, not to scale.
FloorplansUsketch.com © 2021 (ID803594)

Laminghope

12 Shenley Road, Borehamwood, Hertfordshire, WD6 1DL

T: 020 3617 1333

E: enquiries@laminghope.com