



**Fitzwilliam Court, Eaton Way**

Guide Price **£299,950**

**L&H**residential  
laminghope.com **sales & lettings**

## Flat 4

Fitzwilliam Court, Borehamwood

A well presented and modern first floor two bedrooms two bathrooms flat located within easy reach of the local shops, Synagogue and 0.8 miles from Elstree and Borehamwood train station.

Tenure: Share of Freehold

- Modern first floor flat
- Two double bedrooms
- Two bathrooms (one ensuite)
- Allocated parking space
- Communal garden
- 0.8 miles to Elstree and Borehamwood Train Station
- Short walk to shops, schools and Synagogue
- Ample visitor parking spaces



**L&H**residential  
laminghope.com sales & lettings

Borehamwood - 0203 617 1333

Scott Magor

e scott@laminghope.com

t +44 7572 958 043



# Fitzwilliam Court, Eaton Way, WD6

Approximate Gross Internal Area = 55.9 sq m / 602 sq ft

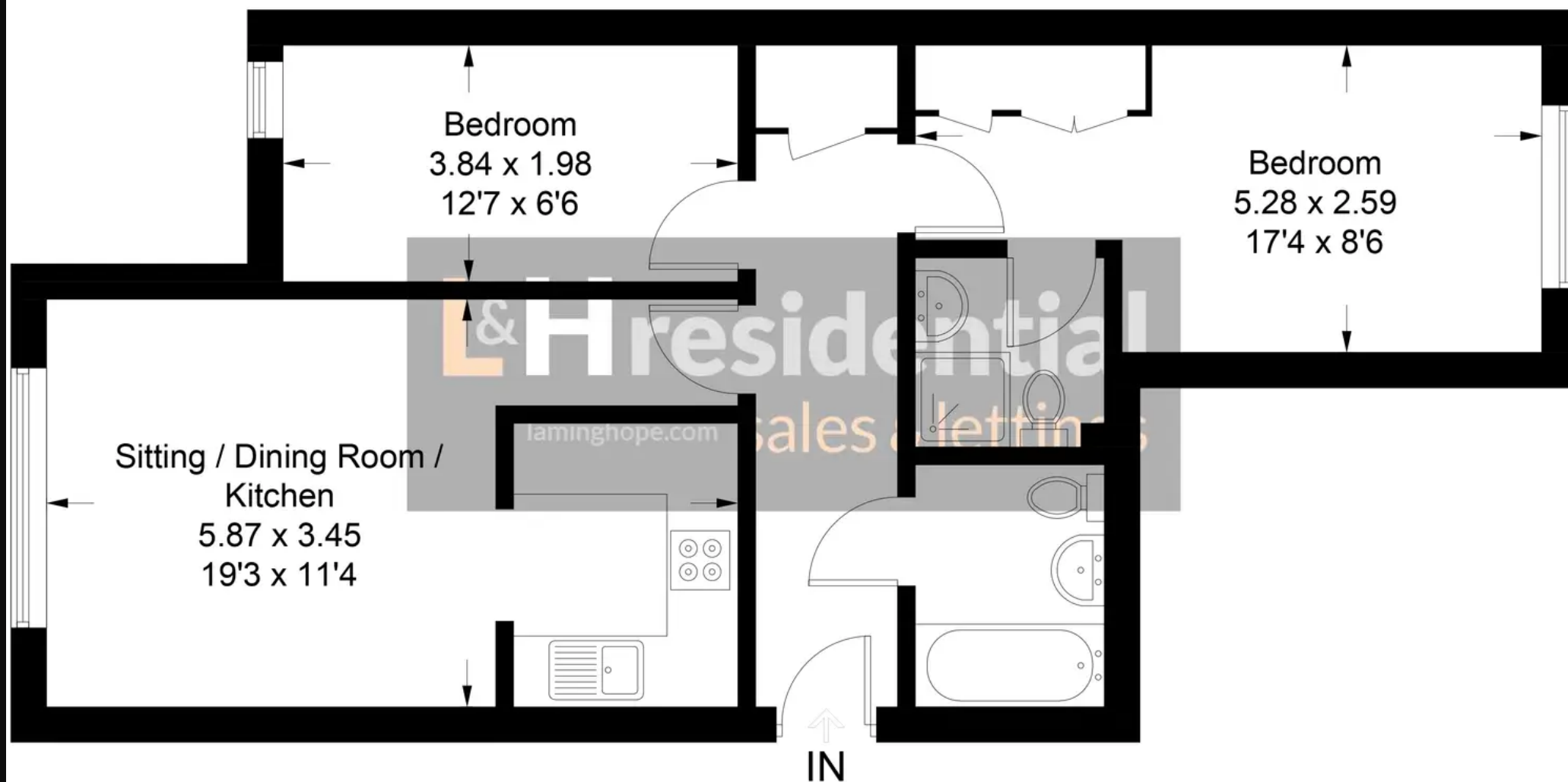

Illustration for identification purposes only, measurements are approximate, not to scale. floorplansUsketch.com © (ID779834)

## WHERE TO FIND US

Borehamwood Branch:  
12 Shenley Road,  
Borehamwood,  
Hertfordshire,  
WD6 1DL

Telephone: 020 3617 1333  
Email: [enquiries@laminghope.com](mailto:enquiries@laminghope.com)