



**7 North Lodge, 46 Somerset Road**

Guide Price **£1,600 pcm**

**L&H**residential  
laminghope.com **sales & lettings**



Available 10th September  
Energy Rating C

Council Tax D - £170 PCM Approx

Any further info required please call  
0203 6171333 or email  
[scott@laminghope.com](mailto:scott@laminghope.com)



#### WHERE TO FIND US

##### Borehamwood Branch:

12 Shenley Road,  
Borehamwood,  
Hertfordshire,  
WD6 1DL

Telephone: 020 3617 1333

Email: [enquiries@laminghope.com](mailto:enquiries@laminghope.com)

020 3617 1333

[enquiries@laminghope.com](mailto:enquiries@laminghope.com)

**L&Hresidential**  
sales & lettings



**L&Hresidential**  
[laminghope.com](http://laminghope.com) sales & lettings

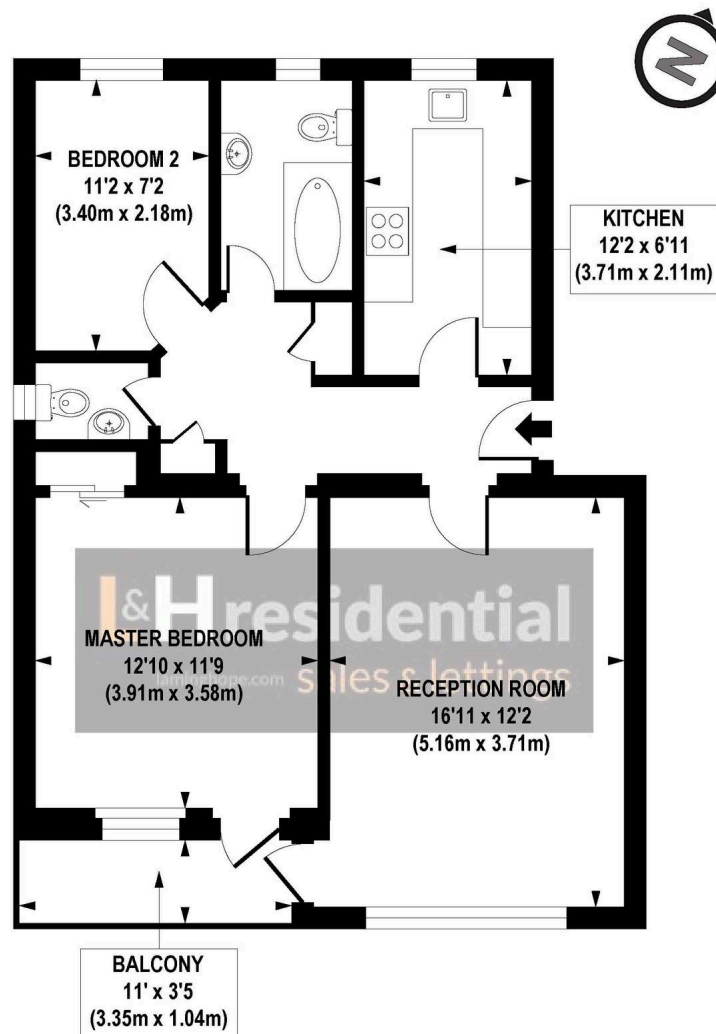

FIRST FLOOR

APPROX. GROSS INTERNAL FLOOR AREA 723 sq. ft / 67.23 sq. m

Floorplan is for illustrative purposes only and is not to scale.  
Every attempt has been made to ensure the accuracy of the floorplan shown, however all measurements, fixtures, fittings and data shown are an approximate interpretation for illustrative purposes only.  
Liability for errors, omissions or mis-statement through negligence or otherwise is hereby excluded.

**CP CREATIVE**  
PROPERTY MARKETING