



111 Horizon Place, Studio Way  
£299,950

**L&H**residential  
laminghope.com sales & lettings

# 111 Horizon Place

Studio Way, Borehamwood

A recently built and ultra modern second floor one bedroom flat with two southerly facing balconies, lift and an allocated parking space.

Tenure: Leasehold

- Recently built second floor one bedroom flat
- Modern open plan living
- Two southerly facing balconies
- Lift
- Communal garden
- Allocated parking space
- Short walk to local shops and bus routes
- One mile from Borehamwood and Elstree train station



**L&H**residential  
laminghope.com sales & lettings

Borehamwood - 0203 617 1333

Scott Magor

e scott@laminghope.com

t +44 7572 958 043

# Horizon Place, Studio Way, WD6

Approximate Gross Internal Area = 48 sq m / 514 sq ft

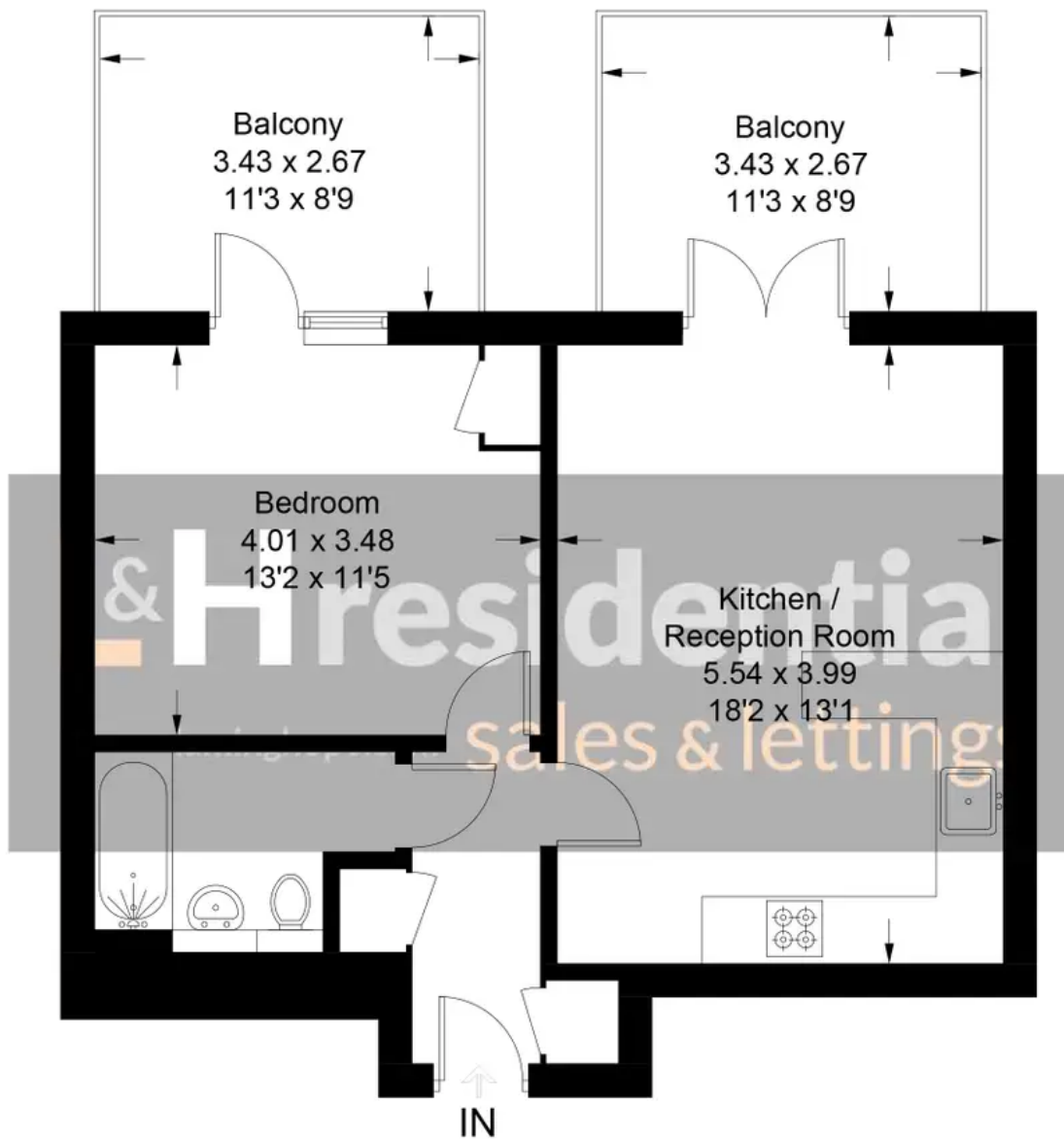

Illustration for identification purposes only, measurements are approximate, not to scale. floorplansUsketch.com © (ID692897)

#### WHERE TO FIND US

Borehamwood Branch:  
12 Shenley Road,  
Borehamwood,  
Hertfordshire,  
WD6 1DL

Telephone: 020 3617 1333  
Email: [enquiries@laminghope.com](mailto:enquiries@laminghope.com)