



6 Wyre Grove, Edgware
£745,000

L&Hresidential
laminghope.com sales & lettings

6 Wyre Grove

Edgware, Edgware

An ultra modern and extended four bedroom detached house located in the ever so popular Broadfields estate.

Tenure: Freehold

- Extended detached house
- Four bedrooms (one downstairs)
- Ultra modern open plan kitchen/living area
- Two reception rooms
- Off street parking + Garage
- Private garden with side access
- Broadfields Estate
- Downstairs guest W.C.
- CHAIN FREE



020 3617 1333

enquiries@laminghope.com

L&H residential
sales & lettings
LAMINGHOPE.COM



Property Details

L&H Residential are proud to bring to the market this ultra modern and extended detached family home located in the ever so popular Broadfields Estate and a short walk to local schools, shops, bus routes and places of worship. The accommodation comprises of four bedrooms, family bathroom, downstairs guest w.c, large open plan kitchen/living area and two reception rooms. The property also benefits from off street parking, garag, private garden with side access and being sold CHAIN FREE.



020 3617 1333

enquiries@laminghope.com

L&H residential
sales & lettings
LAMINGHOPE.COM





Wyre Grove, HA8

Approximate Gross Internal Area = 125.8 sq m / 1354 sq ft
Garage = 13.6 sq m / 146 sq ft
Total = 139.4 sq m / 1500 sq ft

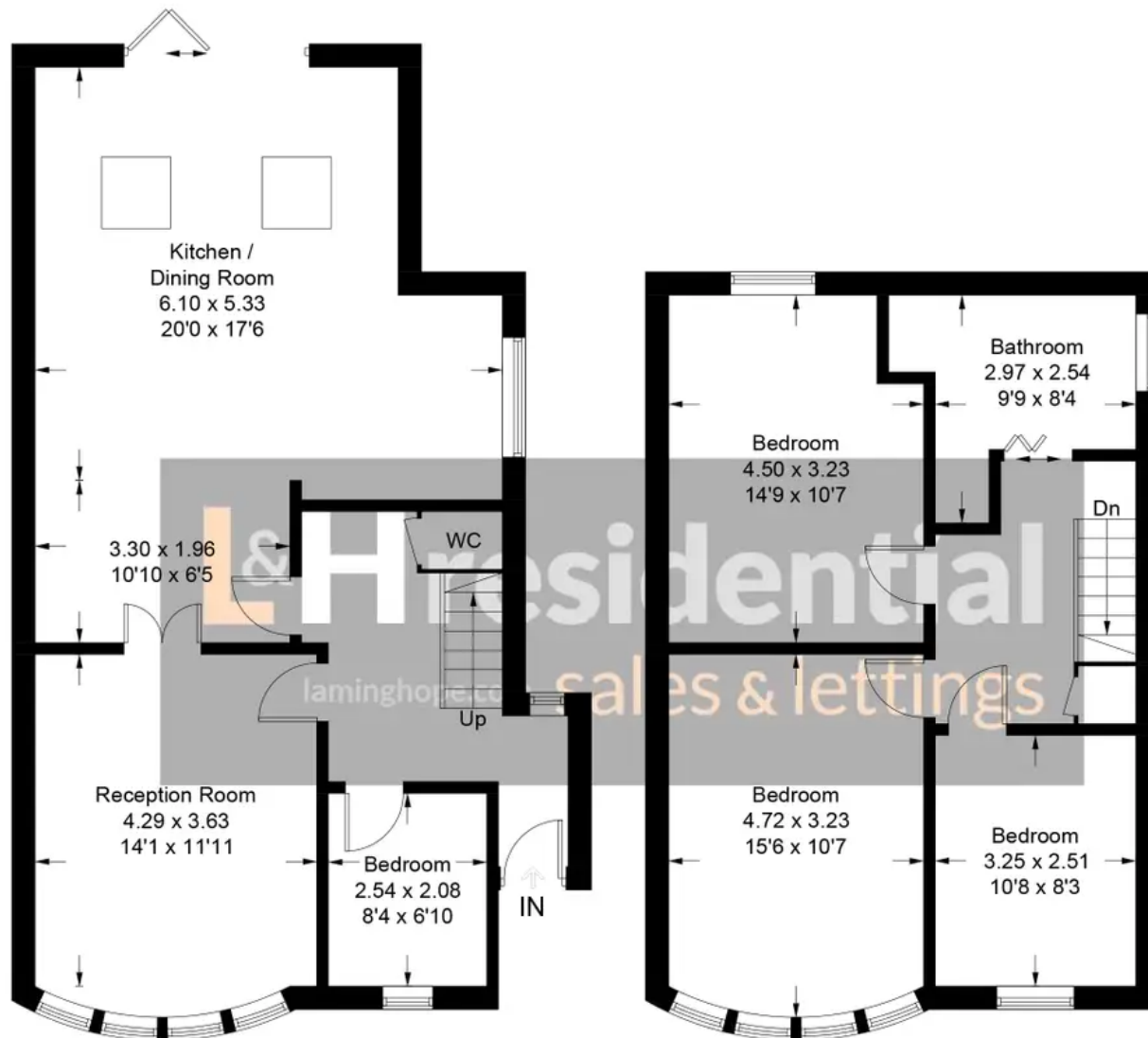

(Not Shown In Actual
Location / Orientation)

WHERE TO FIND US

Borehamwood Branch:
12 Shenley Road,
Borehamwood,
Hertfordshire,
WD6 1DL

Telephone: 020 3617 1333
Email: enquiries@laminghope.com

020 3617 1333
enquiries@laminghope.com

L&Hresidential
sales & lettings

Illustration for identification purposes only, measurements are approximate,
not to scale. floorplansUsketch.com © (ID869256)