



## Foster House, Maxwell Road

Guide Price £220,000

**L&H**residential  
laminghope.com sales & lettings



## Foster House, Borehamwood

CASH BUYERS ONLY. Stylish 1-bed apartment exclusively for cash buyers. Modern 4th floor with lift access, open plan living, private balcony & communal terrace. Neutral décor, ample storage, long lease & allocated parking. Conveniently located 0.7 miles from Elstree & Borehamwood station. Hassle-free chain-free purchase. Perfect investment or pied-à-terre opportunity. Call now to arrange a viewing.

Tenure: Leasehold

- CASH BUYERS ONLY
- Modern fourth floor flat with lift
- One bedroom
- Open plan living space
- Balcony & Communal roof terrace
- Allocated parking space
- 0.7 miles from Elstree & Borehamwood train station
- Long lease
- CHAIN FREE



**L&H residential**  
laminghope.com sales & lettings

**Borehamwood - 0203 617 1333**

**Scott Magor**

e [scott@laminghope.com](mailto:scott@laminghope.com)

t +44 7572 958 043

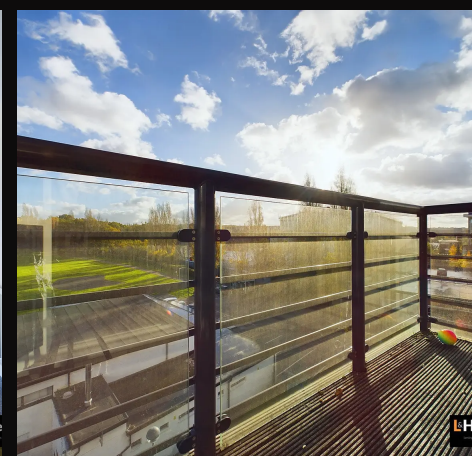

You can include any text here. The text can be modified upon generating your brochure.



**L&Hresidential**  
laminghope.com sales & lettings

**Borehamwood - 0203 617 1333**

**Scott Magor**

e [scott@laminghope.com](mailto:scott@laminghope.com)

t +44 7572 958 043

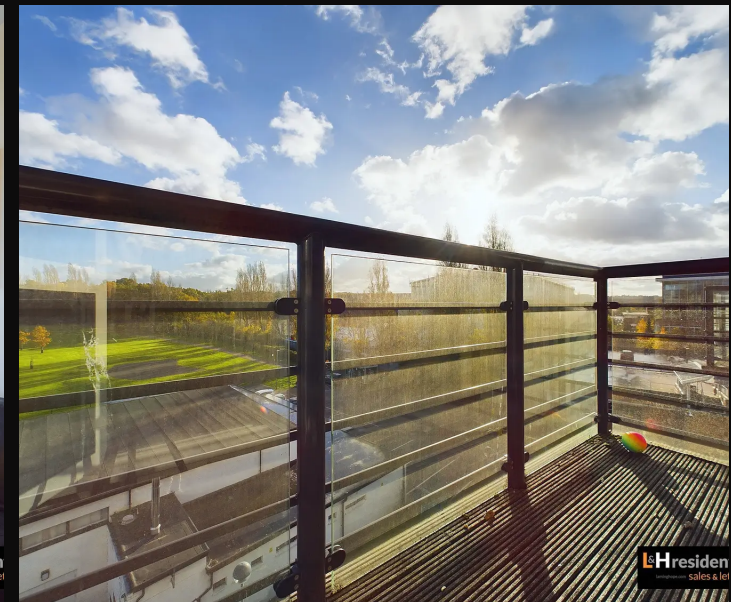

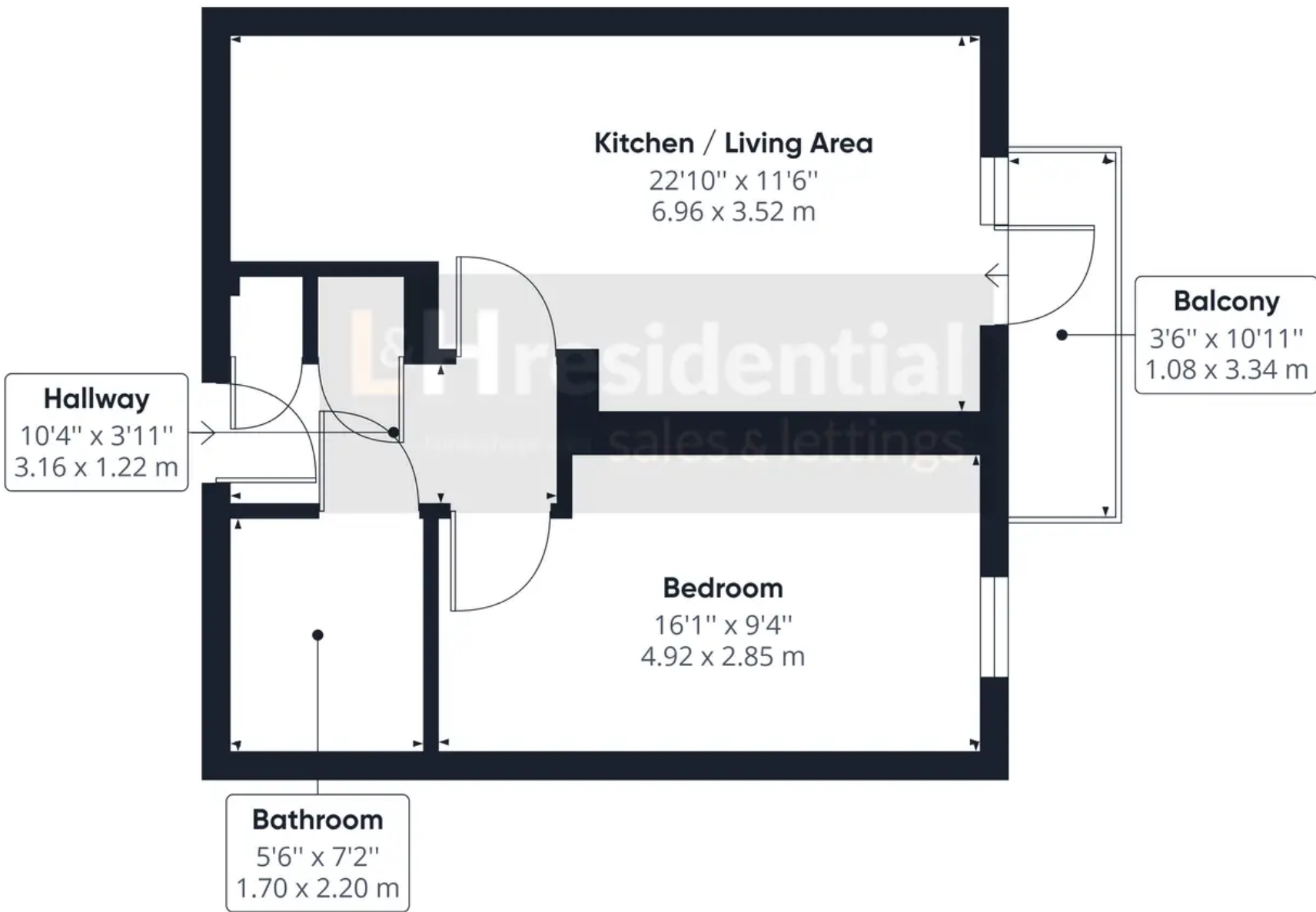

Approximate total area<sup>(1)</sup>  
465.72 ft<sup>2</sup>  
43.27 m<sup>2</sup>

(1) Excl

While ev  
ensure a  
approx  
plan is

