



Affinity Place

£335,000 Leasehold



Stunning 2-bed apartment in modern development with allocated parking and bike shed. Bright open living area with balcony and picturesque views. Convenient location near train station. Ideal for modern, discerning individuals seeking a comfortable and contemporary lifestyle.

L&Hresidential
laminghope.com sales & lettings

020 3617 1333

enquiries@laminghope.com

L&H Residential are proud to introduce a spectacular two-bedroom apartment, situated on the fourth floor of a modern development built in 2017. Boasting an enviable location, this flat offers contemporary living at its finest.

The property features two spacious double bedrooms, providing ample living space for individuals or couples seeking a comfortable home. The open plan living area is drenched in natural light, thanks to its triple aspect, creating a bright and airy atmosphere throughout. Step out onto the balcony to enjoy the refreshing breeze and take in the picturesque views of the surrounding neighbourhood.

This elegant apartment is an opportunity not to be missed. Its modern design, combined with its convenient location and practical features, make it a perfect home for discerning individuals seeking a comfortable and contemporary lifestyle.

Scott Magor

e scott@laminghope.com

t +44 7572 958 043



- Modern fourth floor flat built in 2017 with lift access
- Two double bedrooms
- Open plan living + Balcony
- Allocated underground parking space
- Bathroom with external window
- Triple aspect bringing in an abundance of light
- Bike shed
- Long lease
- 0.8 miles from Elstree & Borehamwood train station



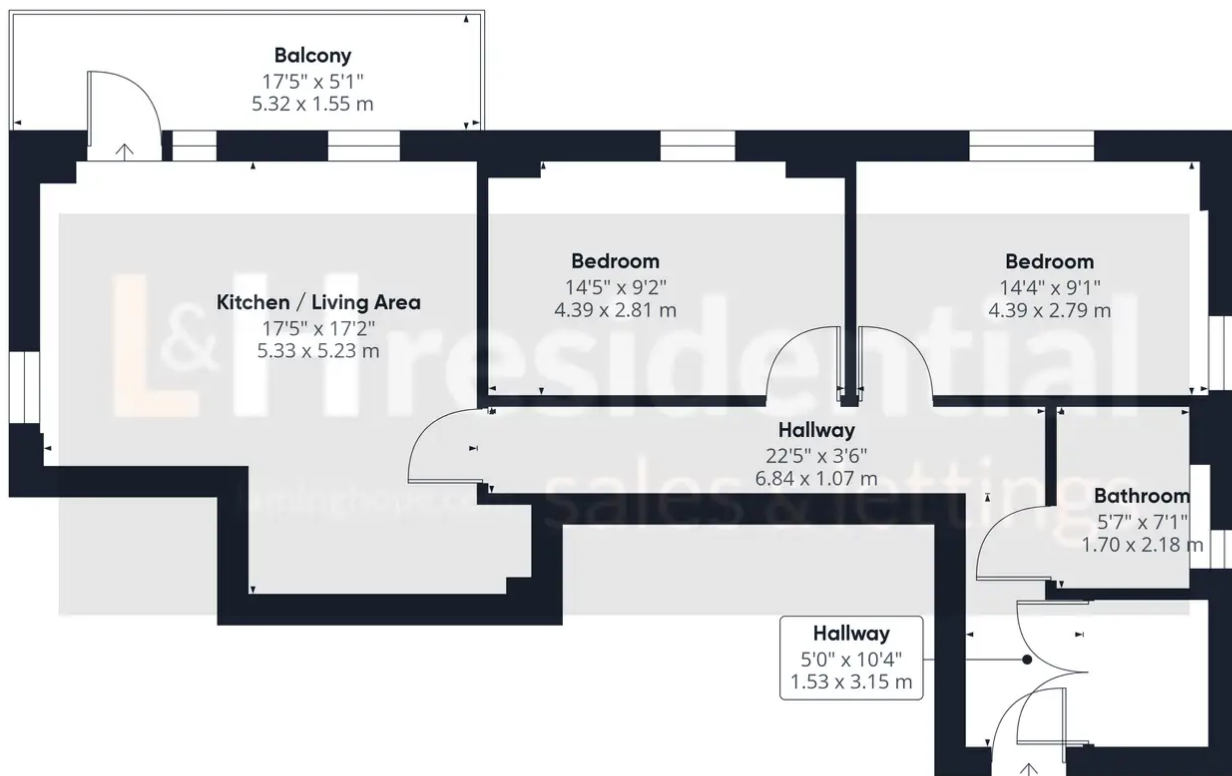

Approximate total area^{sq}
749.68 ft²
69.65 m²

Excluding balconies and terraces

While every attempt has been made to ensure accuracy, all measurements are approximate, not to scale. This floor plan is for illustrative purposes only.

GIRAFFE360