



19 Kenilworth Close, Borehamwood

Guide Price **£599,950**

L&Hresidential
laminghope.com **sales & lettings**



19 Kenilworth Close

Borehamwood, Borehamwood

Don't miss this stylish 3-bed end-of-terrace house, newly built in 2017 with modern design & quality finishes. Open plan living, Yavneh Catchment area, close to transport links, off-street parking, and local amenities. Perfect for discerning buyers seeking a comfortable lifestyle.

Council Tax band: E

Tenure: Freehold

- Ultra modern end of terrace house built in 2017 (still under building guarantee)
- Three double bedrooms
- Downstairs guest W.C.
- Ground floor fully open plan
- Underfloor heating throughout ground floor with dual zone control
- Private 100ft (approx) garden
- Off street parking
- Yavneh Catchment area
- 0.8 miles from Elstree and Borehamwood Train Station

L&Hresidential
laminghope.com sales & lettings

Borehamwood - 0203 617 1333

Scott Magor

e scott@laminghope.com

t +44 7572 958 043



You can include any text here. The text can be modified upon generating your brochure.



L&Hresidential
laminghope.com sales & lettings

Borehamwood - 0203 617 1333

Scott Magor

e scott@laminghope.com

t +44 7572 958 043





Ground Floor

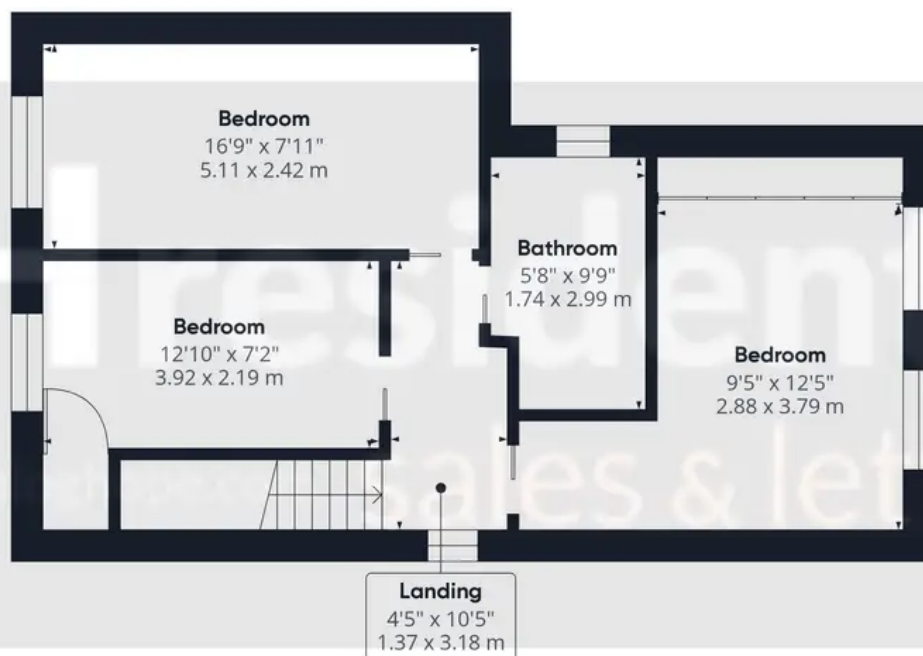

Floor 1

Approximate total area⁽¹⁾

1082.11 ft²

100.53 m²

(1) Excl

While ev
ensure a
approx
plan is

