



## Winter Walk, Borehamwood

### Freehold

Ultra modern end of terraced house in the sought after Hertsmere Mews development • Three bedrooms • Large master bedroom with dressing area • Separate kitchen • Downstairs guest W.C. • Two allocated parking spaces • Two bathrooms (one ensuite) • Air conditioning • 0.7 miles from Elstree & Borehamwood train station • Short walk to local schools, shops and bus routes



L&H Residential are proud to present an impeccable opportunity to own an ultra-modern residence, this stunning 3-bedroom end-of-terrace house is nestled within the esteemed Hertsmere Mews development. Boasting a blend of luxury and functionality, this residence features a spacious master bedroom complemented by a convenient dressing area, along with two additional well-appointed bedrooms. The property further comprises a separate kitchen, two bathrooms including an ensuite, and a thoughtfully added downstairs guest W.C., offering utmost convenience for residents and guests alike.

Scott Magor

e [scott@laminghope.com](mailto:scott@laminghope.com)

t +44 7572 958 043



- Ultra modern end of terraced house in the sought after Hertsmere Mews development
- Three bedrooms
- Large master bedroom with dressing area
- Separate kitchen
- Downstairs guest W.C.
- Two allocated parking spaces
- Two bathrooms (one ensuite)
- Air conditioning
- 0.7 miles from Elstree & Borehamwood train station
- Short walk to local schools, shops and bus routes



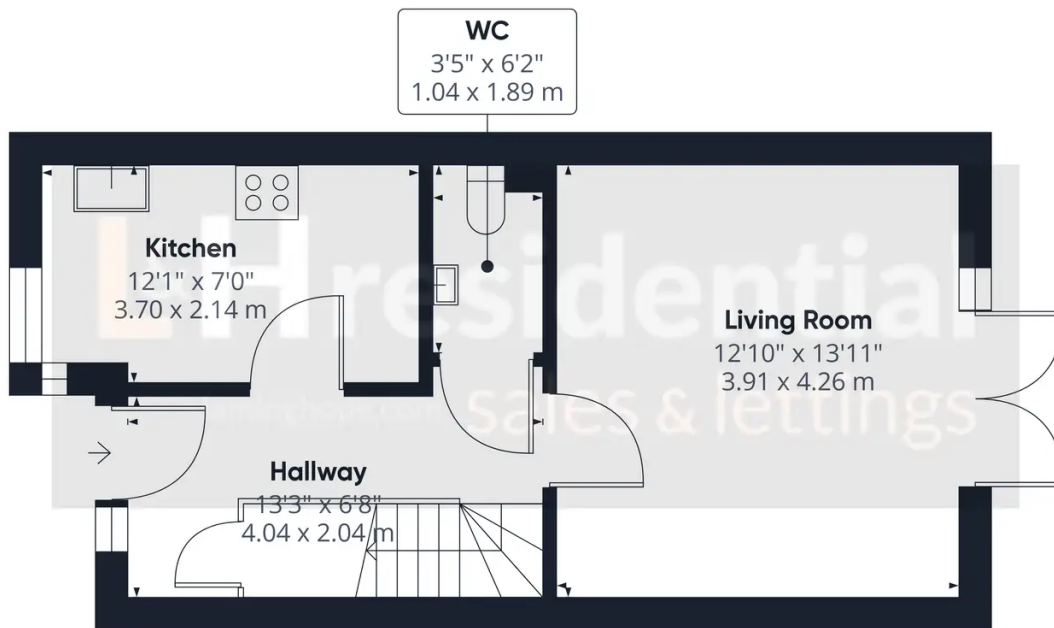

Approximate total area<sup>(1)</sup>  
389.86 ft<sup>2</sup>  
36.22 m<sup>2</sup>

(1) Excluding balconies and terraces

While every attempt has been made to ensure accuracy, all measurements are approximate, not to scale. This floor plan is for illustrative purposes only.

GIRAFFE360

Ground Floor

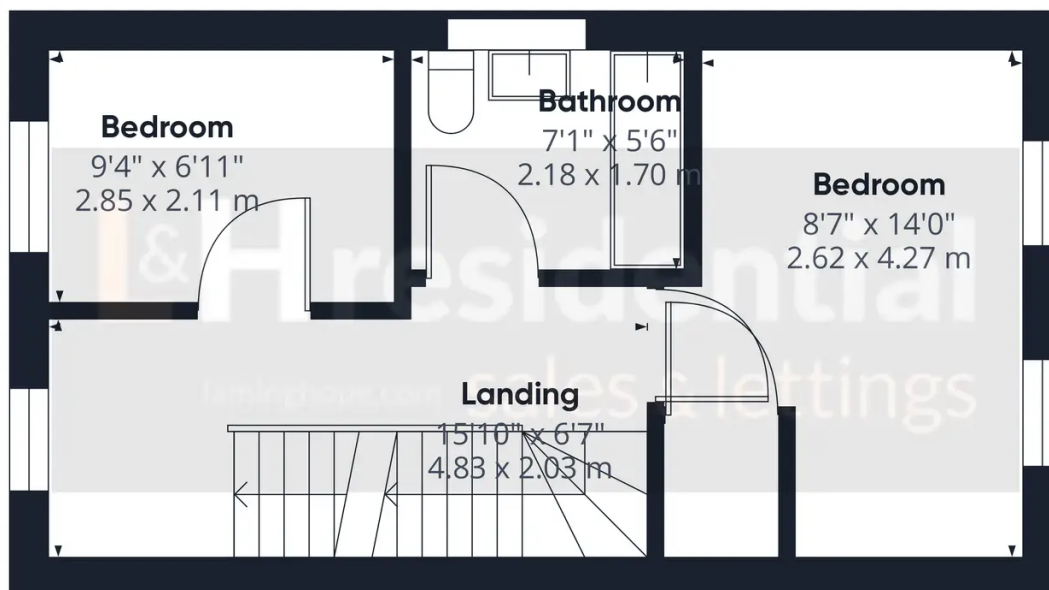

Approximate total area<sup>(1)</sup>  
348.02 ft<sup>2</sup>  
32.33 m<sup>2</sup>

(1) Excluding balconies and terraces

While every attempt has been made to ensure accuracy, all measurements are approximate, not to scale. This floor plan is for illustrative purposes only.

GIRAFFE360

Floor 1

