



Elstree House, Elstree Way

£1,900 pcm

L&H residential
laminghope.com **sales & lettings**

Available 29th August

If you wish to rent the property then please email

scott@laminghope.com

We will need the following information in your application to rent the property.

How many people is the property for?

Full names of the persons to live in the property? What jobs do people do?

Salary?

When do you want to move?

Any other questions you have?

We look forward to hearing from you soon.



WHERE TO FIND US

Borehamwood Branch:

12 Shenley Road,
Borehamwood,
Hertfordshire,
WD6 1DL

Telephone: 020 3617 1333

Email: enquiries@laminghope.com

020 3617 1333

enquiries@laminghope.com

L&H residential
sales & lettings



L&H residential
laminghope.com sales & lettings

L&H residential
sales & lettings

L&H residential
sales & lettings

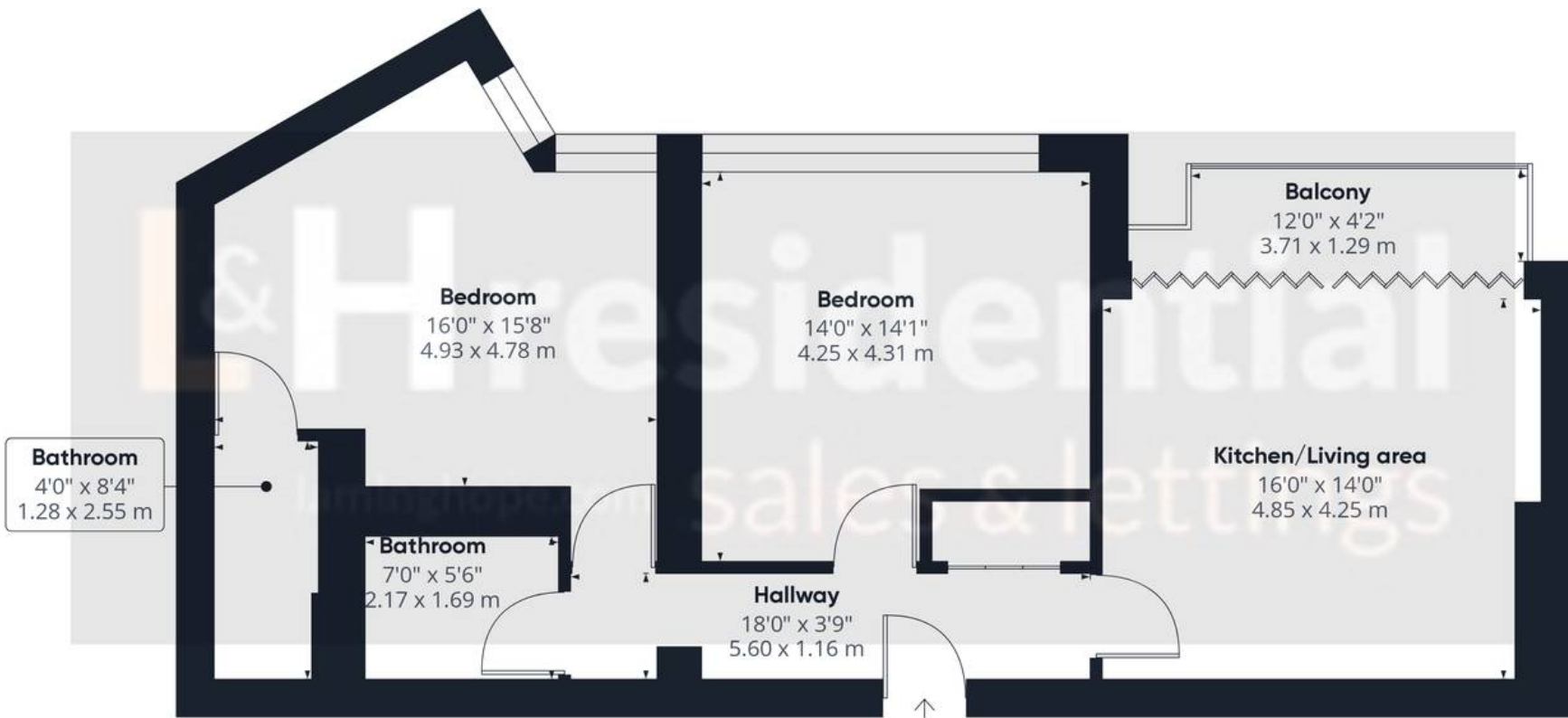

Approximate total area⁽¹⁾

778.77 ft²

72.35 m²

(1) Excluding balconies and terraces

While every attempt has been made to ensure accuracy, all measurements are approximate, not to scale. This floor plan is for illustrative purposes only.

GIRAFFE360