



## Heaton House Thurston Way, Borehamwood

£300,000 Leasehold

Recently built modern second (top) floor flat • One double bedroom • Open plan living & Large balcony • Allocated parking space • 0.7 miles from Elstree and Borehamwood train station • Long lease & Low service charges • CHAIN FREE 635SQFT

**L&H residential**  
laminghope.com sales & lettings

L&H Residential are proud to be presenting a fantastic opportunity to acquire a contemporary lifestyle, this recently built, modern second-floor flat offers a comfortable and stylish living space.

Situated in a sought-after location just 0.7 miles from Elstree and Borehamwood train station, commuting is made effortless for the new owners. With the added benefits of a long lease and low service charges, this property presents an excellent investment opportunity or ideal first home. Offered chain-free and measuring approximately 635 sq ft, this residence guarantees modern convenience and comfort in a prime location. Arrange a viewing today and experience the appeal of this one-bedroom flat firsthand.



- Recently built modern second (top) floor flat
- One double bedroom
- Open plan living & Large balcony
- Allocated parking space
- 0.7 miles from Elstree and Borehamwood train station
- Long lease & Low service charges
- CHAIN FREE 635SQFT

020 3617 1333

[enquiries@laminghope.com](mailto:enquiries@laminghope.com)

**L&H residential**  
sales & lettings



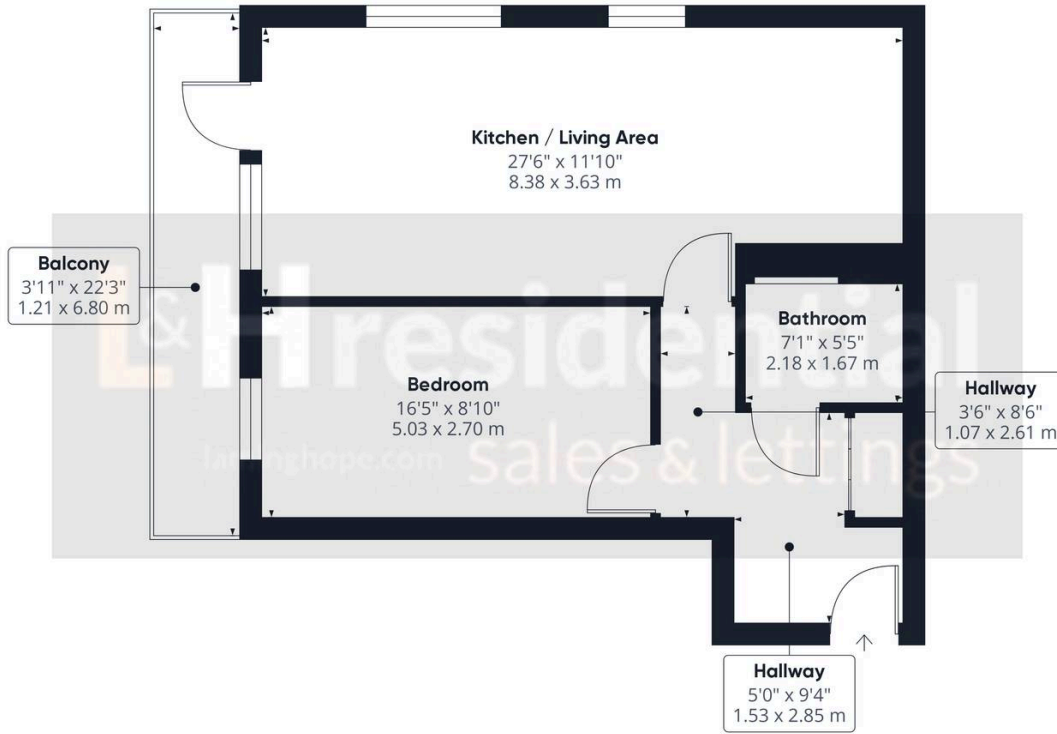

**Approximate total area<sup>(1)</sup>**

609.66 ft<sup>2</sup>  
56.64 m<sup>2</sup>

**Balconies and terraces**

87.73 ft<sup>2</sup>  
8.15 m<sup>2</sup>

(1) Excluding balconies and terraces

While every attempt has been made to ensure accuracy, all measurements are approximate, not to scale. This floor plan is for illustrative purposes only.

Calculations are based on RICS IPMS 3C standard.

GIRAFFE 360