

Willow Tree Court Balmoral Drive, Borehamwood

£399,950 Leasehold

Ground floor three bedroom flat • Two bathrooms • Large reception • Beautifully presented • Private terrace and Direct access to communal gardens • Block of just two flats • Allocated parking space • Long Lease & Low Service Charge • Short Walk to Shops, Bus Routes and Park

L&Hresidential
laminghope.com sales & lettings

L&H Residential are proud to bring to the market this spacious flat nestled within a quaint block of just two flats, this stunning ground floor three-bedroom apartment offers a contemporary and comfortable living space in a sought-after location. The property boasts a beautifully presented interior, comprising of a spacious reception room, ideal for relaxation and entertainment. The apartment features two modern bathrooms, ensuring convenience and privacy for residents. Access to a private terrace and direct entry to communal gardens provide a tranquil outdoor escape.



020 3617 1333

enquiries@laminghope.com

L&H residential
sales & lettings



- Ground floor three bedroom flat
- Two bathrooms
- Large reception
- Beautifully presented
- Private terrace and Direct access to communal gardens
- Block of just two flats
- Allocated parking space
- Long Lease & Low Service Charge
- Short Walk to Shops, Bus Routes and Park



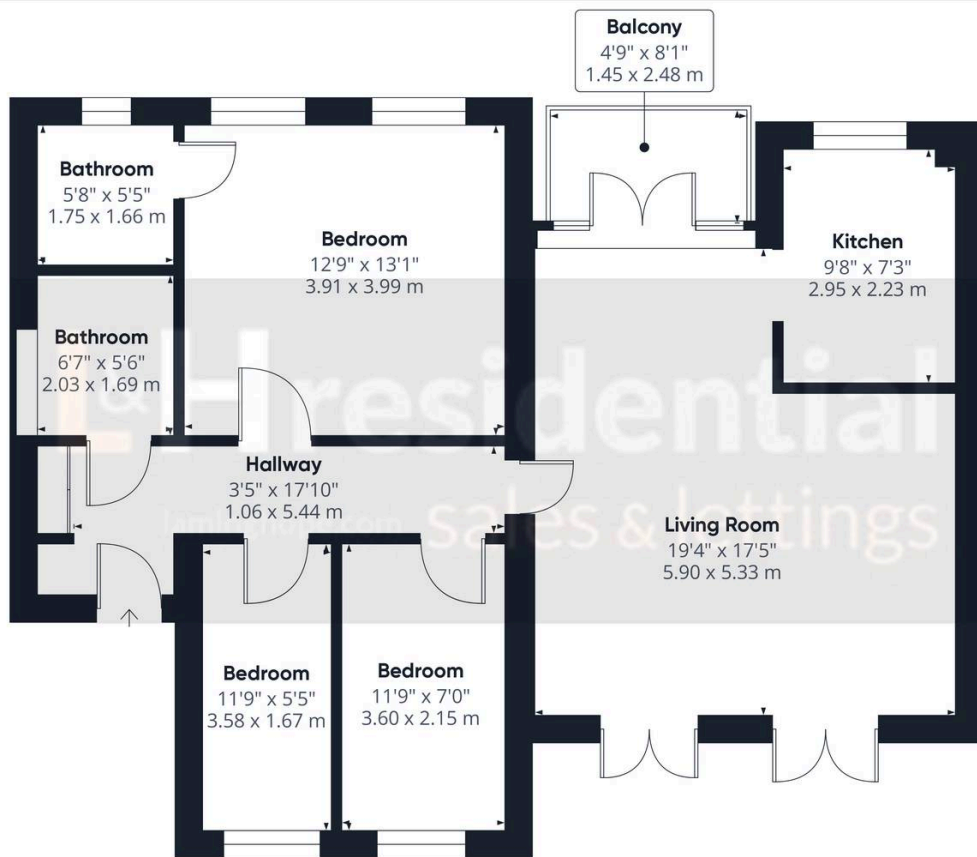

Approximate total area[®]

857.45 ft²
79.66 m²

Balconies and terraces

38.53 ft²
3.58 m²

(1) Excluding balconies and terraces

While every attempt has been made to ensure accuracy, all measurements are approximate, not to scale. This floor plan is for illustrative purposes only.

Calculations are based on RICS IPMS 3C standard.

GIRAFFE 360